

FFB-VS VentiStop cavity barrier. Installation instructions.



Product details



Functionality

- FFB-VS VentiStop is a foil-faced stone wool pre-cut unit, which has a powerful intumescent graphite strip bonded to the leading edge. The intumescent graphite strip is pre-wrapped with a durable polythene adhesive sheet to prevent water ingress.
- FFB-VS has been designed to provide a 25 mm or 50 mm ventilation gap, that allows air flow and moisture to pass down the back of the cladding. Under fire conditions, the powerful intumescent along the leading edge expands horizontally to close the gap and prevent the passage of fire.

Your advantages at a glance

- Tested up to 120 minutes integrity and 120 minutes insulation, utilising the heating and pressure conditions of EN 1363-1: 2012 and ASFP TDG19: 2014 - Open State Cavity Barriers.
- Suitable for close up to 25 mm, 38 mm & 50 mm ventilation gap.
- Voids up to 450 mm wide.
- Free of halogens, asbestos, fibres and silica and is non-toxic.
- Contributes to green building.

Tools, equipment, health and safety



Tape measure



Pencil



Straight edge



Pad saw



Safety boots



Reflective vest



Protection goggles



Head protection



Safety gloves

Installation details

Note installation instructions: FireStop material must be installed in accordance with detailed instruction or the approved system.

Preparation

- Enable access or suitable working platform.
- Ensure that all surfaces are free from loose debris and contaminants.
- Mark positioning of barrier on structure according to the building design.

Storage & disposal

- FFB-VS VentiStop is not affected by an outdoor environment.
- However, for long term storage and ease of installation it is recommended that it should be stored in dry conditions.
- For a copy of the health and safety details refer to fischer MSDS sheet.

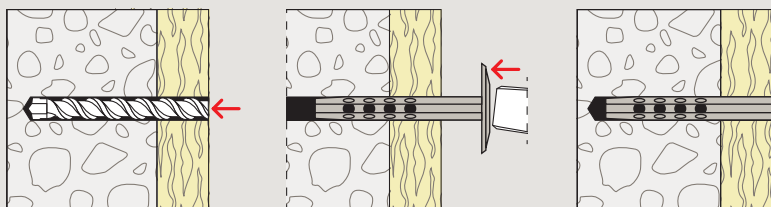

Installation instructions · Solid structure applications and barriers <260mm:

1. Position the fischer FFB-VS VentiStop Cavity Barrier in the required position and using an 8 mm drill diameter, drill through the leading edge of the barrier into the supporting solid structure. The drill hole should be at mid height and spaced no more than 300 mm centres.
2. Position the barrier and insert the fischer DHM Metal Insulation Anchor.
3. Using a hammer tap the fischer DHM Metal Insulation Anchor into position so the head is just starting to compress the leading edge of the fischer FFB-VS VentiStop Cavity Barrier.

Note: The drill must be long enough to penetrate the complete barrier and the required embedment depth for the fischer DHM Metal Insulation Anchors.

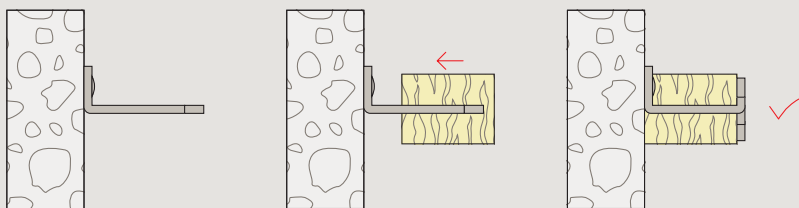

Installation instructions · Light weight framing system and barriers >260mm:

1. Position the fischer Multi-Purpose bracket in required location and using any suitable self-drill, self-tapping screw, attach firmly to substrate. For concrete substrates use appropriate concrete anchors.
2. Inplace the fischer FFB-VS VentiStop Cavity Barrier on to Multi-Purpose Bracket at mid height and push fischer FFB-VS VentiStop Cavity Barrier firmly back to structure.
3. Bend the ends of the fischer Multi-Purpose Bracket in opposite directions to secure the fischer FFB-VS VentiStop into position.

Note: The bent tabs of the fischer FFB-VS VentiStop Cavity Barrier should be between 1/2 in. (13 mm) to 1 in. (25 mm) only. Seal all joints and connections of the barriers with a suitable aluminum tape from both sides of the barrier. Do not use the tape on the front side of the barrier where it might disturb the intumescent from activating.



Your dealer:

www.fischer-international.com



fischer stands for

Fixing Systems
Automotive
fischertechnik
Consulting
Electronic Solutions

fischerwerke GmbH & Co. KG
Klaus-Fischer-Straße 1 · 72178 Waldachtal
Germany
T +49 7443 12 - 0 · F +49 7443 12 - 4222
www.fischer.de · firestop@fischer.de

fischer fixings UK Ltd.
Whitely Road · Oxon OX10 9AT Wallingford
Great Britain
T +44 1491 827900 · F +44 1491 827953
www.fischer.co.uk · info@fischer.co.uk
