

**FCFcl Cavity Clad.**  
Effective & efficient fire  
stopping seal for the  
building envelope.

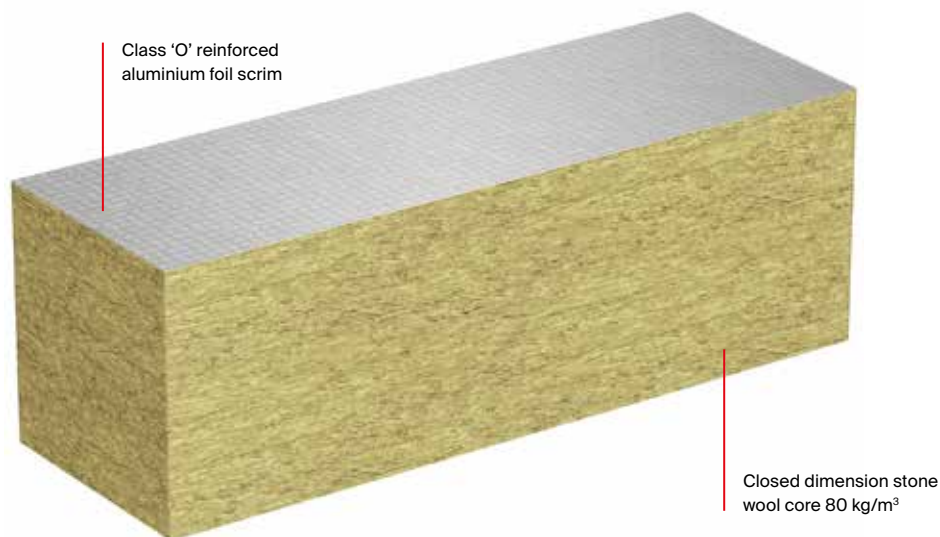

# Product details



## Functionality

- FCFcl Cavity Clad comprises of a 80 kg/m<sup>3</sup> one piece closed dimension stone wool core. The product is encased with an aluminum foil face which provides class 'O' rating and exhibits excellent resistance to smoke.
- The FCFcl Cavity Clad provides a resilient lateral compression which is required to ensure a tight fit. Tested BS 476 & EN 1366-4 the FCFcl has been classified to EN 13501-1 and bears the CE mark.

## Your advantages at a glance

- GWP of 0% Global Warming Potential.
- ODP of 0% Ozone Depletion Potential.
- Encased fibre migration for air plenum use.
- Life expectancy of over 30 years.
- Contributes to green building.
- Floor & wall voids up to 500mm wide.

## Tools, equipment, health and safety



Tape measure



Pencil



Straight edge



Pad saw



Safety boots



Reflective vest



Protection goggles



Head protection



Safety gloves

# Installation details

**Note installation instructions:** Firestop material must be installed in accordance with detailed instruction or the approved system.

## Preparation

- Enable access or suitable working platform.
- Ensure that all surfaces are free from loose debris and contaminants.
- Mark positioning of barrier on structure according to the building design.

## Storage & disposal

- FCFcl Cavity Clad is not affected by an outdoor environment.
- However, for long term storage and ease of installation it is recommended that it should be stored in dry conditions.
- For a copy of the health and safety details refer to fischer MSDS sheet.

### FCFcl installation in curtain wall (horizontal)

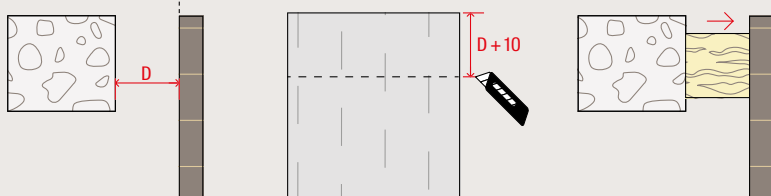

### FCFcl installation in rainscreen (vertical)

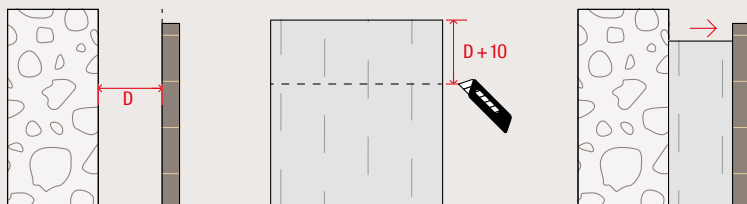

Seal all joints on foil side with appropriate aluminium tape.

### Installation Instructions - Solid structure & light weight framing system application:

1. Position the fischer Multi-Purpose Bracket in required location and using an suitable anchor, attach firmly to substrate.
2. Impale the fischer FCFcl Cavity Clad on to Multi-Purpose Bracket at mid height.
3. FCFcl Cavity Clad should not penetrate through complete barrier.

**Note:** The FCFcl Cavity Clad shall be installed with a Min. 10mm compression. The FCFcl Cavity Clad shall be impaled onto the fischer Multi-Purpose Bracket but shall only penetrate barrier 2/3 of the way through.

## Certificates



British Standard  
BS 476 - 20

BS EN1366-4: 2006

BS EN ISO 10140-3 : 1995

BS EN 1026



APPROVED  
PRODUCTCF5659

Your dealer:

[www.fischer-international.com](http://www.fischer-international.com)



**fischer stands for**

Fixing Systems  
Automotive  
fischertechnik  
Consulting  
LNT Automation

---

**fischerwerke GmbH & Co. KG**  
Klaus-Fischer-Straße 1 · 72178 Waldachtal  
Germany  
T +49 7443 12 - 0 · F +49 7443 12 - 4222  
[www.fischer.de](http://www.fischer.de) · [info@fischer.de](mailto:info@fischer.de)

**fischer fixings UK Ltd.**  
Whitely Road · Oxon OX10 9AT Wallingford  
Great Britain  
T +44 1491 827900 · F +44 1491 827953  
[www.fischer.co.uk](http://www.fischer.co.uk) · [info@fischer.co.uk](mailto:info@fischer.co.uk)

---