

RGB COLOR SENSOR

Art. Nr. 213965

I2C sensor provides the measured RGBW raw values for red green blue and white. Light is emitted by white LEDs and reflected by different colors in different ways. The reflected amount of light is measured per channel (RGBW). The measured value depends on the brightness in the environment and the distance to the object. RGB color sensor has an integrated LED light source consisting of three white LEDs that can be controlled in brightness. The sensor offers many other additional functions, which are described in more detail in the I2C data communication protocol of the sensor.

Dimensions	45x30x19,2 mm
Weight	14 g
Supply voltage	3,3 V

PIN assignment



The RGB color sensor can be connected to the EXT1 or EXT2 port. Example of connection to the TXT 4.0 Controller:

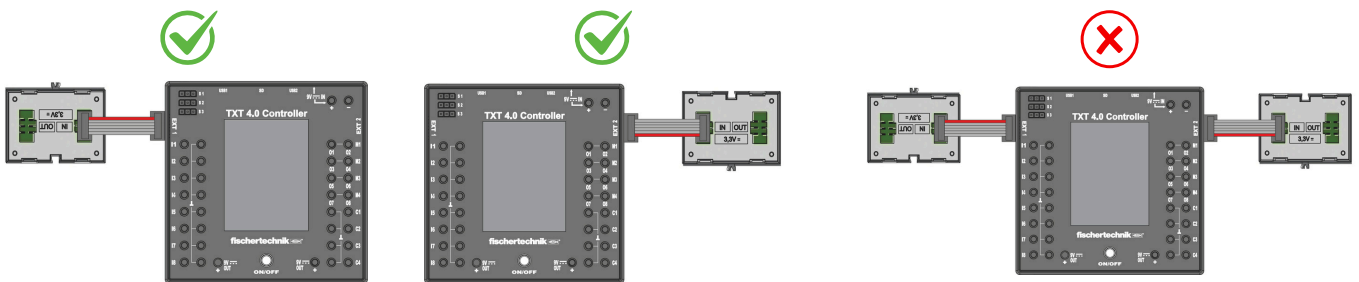

Up to 8 RGB color sensors can be connected. Additional color sensors are connected at their IN connection to the OUT connection of a previous color sensor.

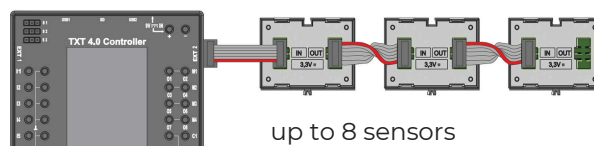

Power the controller only after connecting the sensors. Otherwise, connecting chained sensors later may cause a crash of the TXT 4.0 controller.

