

Installation Instruction fischer bolt anchor FAZ II Plus with cap nut



fischer Bolt anchor FAZ II Plus with cap

fischer setting gauge

Push through installation of the cap nut version with setting gauge

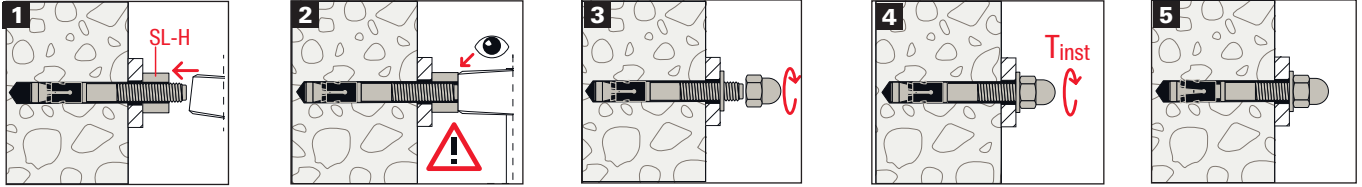

1 Set the fastener.

2 Check offset.

3 Fit the washer and turn on cap nut.

4 Apply installation torque.

5 Finished!

*Installation data

Bolt anchor FAZ II Plus (cap nut version)

Item	Drill diameter d_0 [mm]	Min. drill hole depth for push-through installation h_2 [mm]	Anchor length l [mm]	Maximum embedment depth with respective usable length		Minimum embedment depth with respective usable length		Thread $\varnothing \times \text{length}$ [mm]	Diameter of the through hole in the attachment $\leq d_t$ [mm]	Torque moment T_{inst} [Nm]
				$h_{ef, max.}$ [mm]	t_{fix} [mm]	$h_{ef, min.}$ [mm]	t_{fix} [mm]			
FAZ II Plus 10/10 H	10	85	95	60	10	40	30	M 10 x 53	12	45
FAZ II Plus 10/20 H	10	95	105	60	20	40	40	M 10 x 63	12	45
FAZ II Plus 12/10 H	12	99	110	70	10	50	30	M 12 x 61	14	60
FAZ II Plus 12/20 H	12	109	120	70	20	50	40	M 12 x 71	14	60

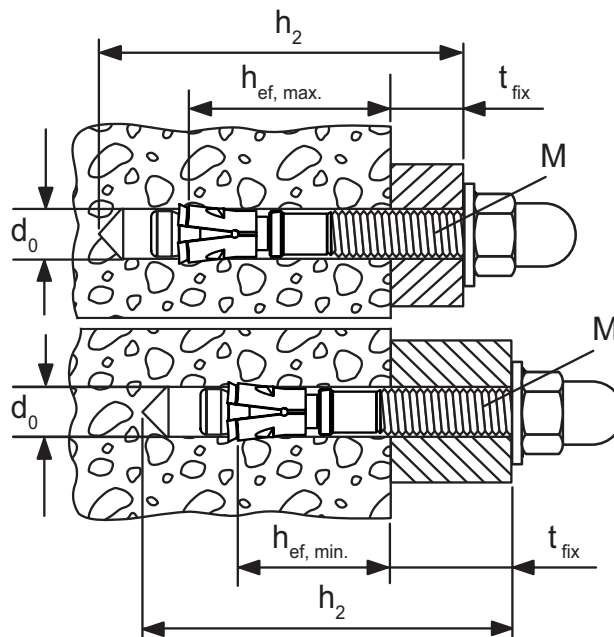

*The attachment must lie directly against the concrete in the area of the anchoring before installation. The bolt anchor must not be driven in with the cap nut screwed on.