

Sound insulated fixed point FSFP

The compact fixed point with a sound insulation insert



Sound insulated fixpoint at ceiling

Applications

- Prevention of unwanted displacement between the pipes and the structures.
- Ensuring of the expansion into the desired direction.
- For use in dry interior areas.

Advantages

- The supports and braces on one or both sides of the variable fixed point allow adaptation to the distance of the pipeline to the subsoil
- The fixed points consist of components with matching thread sizes and plug holes, thus ensuring easy assembly with the same tools.
- The height adjustment on the base plate allows for precise adjustment to match mounted pipelines and therefore ensures the safe function of the fixed point.

Properties

- Clamp strap: StW22 (material no. 1.0032)
- Base plate: S235JR (material no. 1.0038)
- Zinc plating: electro zinc-plated
- Elastomer: ISO 1629 SBR/EPDM chlorine-free and silicone-free
- Temperature range: -40 °C to +100 °C

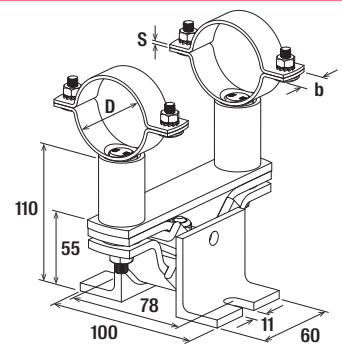

FSFP

Technical data

Item	Item no.	Size [in]	Clamping range D [mm]	Locking screw	Width x thickness clamp band b x s [mm]	Sales unit [pcs]
FSFP 1"	512716	1	33.7	M6	20 x 1.5	1
FSFP 1 1/4"	512717	1 1/4	42.4	M6	20 x 2	1
FSFP 1 1/2"	512718	1 1/2	48.3	M6	20 x 2	1
FSFP 2"	512719	2	60.3	M8	22 x 1.5	1
FSFP 2 1/2"	512720	2 1/2	76.1	M8	22 x 1.5	1

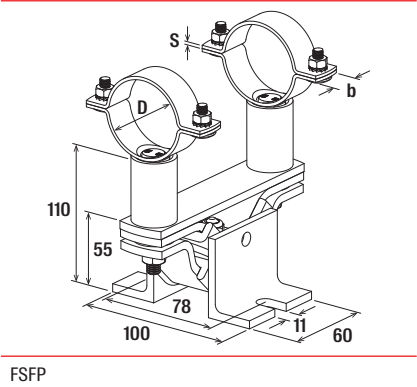

Technical data

6

	Item no.	Size [in]	Clamping range D [mm]	Locking screw	Width x thickness clamp band b x s [mm]	Sales unit [pcs]
Item						
FSFP 3"	512721	3	88.9	M8	22 x 1.5	1
FSFP 4"	512722	4	114.3	M8	22 x 1.5	1