

Sliding hanger SB

Sliding hanger SB - the lightweight sliding element with fire test report

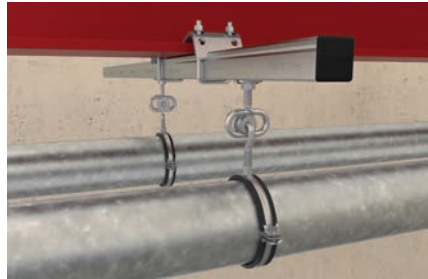

Channel with sliding element



Channel to steelbeam

Applications

- Adjustments of axial length to pipelines.
- Installation of sliding elements in line with the expected length expansions (Ensuring that no sliding distance is lost and sliding isn't inhibited).
- For use in dry interior areas.

Advantages

- The design of the sliding hanger allows pipes to be mounted securely and easily.
- The sliding hanger is ideally suited to adjust the axial length of pipelines.

Properties

- Material: steel DD11 (material no. 1.0332) acc. to DIN EN 10111
- Zinc plating: electro zinc-plated

Certificates

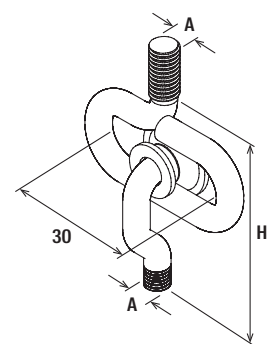

SB

Technical data

| Item | Item no. | Fire test report | Height H [mm] | Max. recom. static load (centr. tension) [kN] | Sales unit [pcs] |
|---------|----------|------------------|---------------|-----------------------------------------------|------------------|
| SB M 8 | 079680 | – | 75 | 0.40 | 25 |
| SB M 10 | 079681 | Yes | 90 | 0.65 | 25 |

For load information under fire exposure, see chapter Basic knowledge.