

Beam clamp TKR

Beam clamp for fixing of profiles to steel girders

4



Channel to steelbeam

Applications

- Fixing to steel girders requires two clamps per connection.
- For use in dry interior areas.

Advantages

- The design of the beam clamp allows fixing without drilling or welding.
- The various lengths of the beam clamp enable the fixing on most standard beams.
- The shape of the beam clamp allows the simple adjustment of the channel connection.

Properties

- Material plate/U-bolt pipe hanger: steel S235JR (material no. 1.0037) acc. to DIN EN 10025
- Material hexagon nut: steel resistance class 8
- Zinc plating: electro zinc-plated

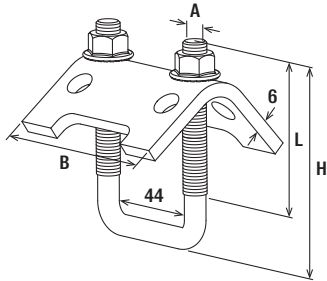

TKR

Technical data

	Item no.	For profile	Thread A	Width B [mm]	Height H [mm]	Length L [mm]	Sales unit [pcs]
Item							
TKR 21 - 42	504363	21, 41	M8	79	97	50	20
TKR 82	504366	62, 41D	M10	79	137	80	20
TKR 124	504367	62	M10	79	179	80	10

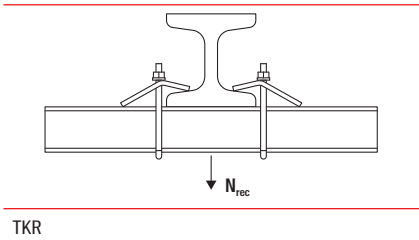

Loads

	Item no.	Max. recom. static load (centr. tension) N_{rec} [kN]	Tightening torque T_{inst} [Nm]	Max. clamping range girders [mm]	Sales unit [pcs]
Item					
TKR 21 - 42	504363	5.00	15	25	20
TKR 82	504366	10.00	20	25	20
TKR 124	504367	10.00	20	25	10

Beam clamp TKR hdg

Beam clamp TKR hdg - Clamp for fixing of profiles to steel girders



Channel to steelbeam

10

Applications

- Fixing to steel girders.
- For indoor and outdoor application.

Advantages

- The design of the beam clamp allows fixing without drilling or welding.
- The various lengths of the beam clamp allow the fixing on most standard beams.
- The shape of the beam clamp allows a simple adjustment of the channel connection.

Properties

- Material plate / U-bolt pipe hanger: steel S235JR (material no. 1.0037) acc. to DIN EN 10025
- Material hexagon nut: steel resistance class 8
- Zinc plating: hot-dip galvanised

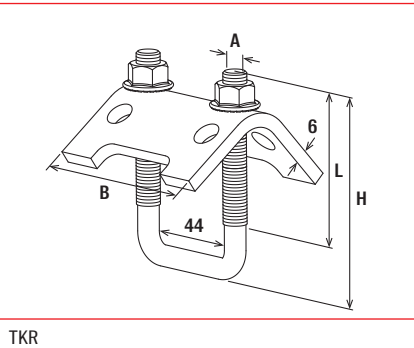

TKR

Technical data

	Item no.	For profile	Thread A	Width B [mm]	Height H [mm]	Length L [mm]	Sales unit [pcs]
Item							
TKR 21- 42 hdg	538122	21, 41	M10	79	97	48	20
TKR 82 hdg	538123	62, 41D	M10	79	137	80	20
TKR 124 hdg	538124	62	M10	79	179	80	10

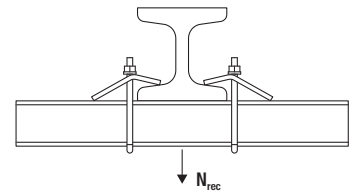

TKR

Loads

		Max. recom. static load (centr. tension)	Tightening torque	Max. clamping range girders	Sales unit
	Item no.	N_{rec} [kN]	T_{inst} [Nm]	[mm]	[pcs]
Item					
TKR 21- 42 hdg	538122	10.00	20	25	20
TKR 82 hdg	538123	10.00	20	25	20
TKR 124 hdg	538124	10.00	20	25	10

Beam clamp TKR A4

Clamp for fixing of profiles to steel girders



12

Applications

- Fixing to steel girders requires two clamps per connection.
- For indoor and outdoor applications and in environments with high stress to components due to corrosion.

Advantages

- The design of the beam clamp allows fixing without drilling or welding.
- The various lengths of the beam clamp enable the fixing on most standard beams.
- The shape of the beam clamp allows the simple adjustment of the channel connection.

Properties

- Material: stainless steel A4 (material no 1.4401) acc. DIN EN 10088-3

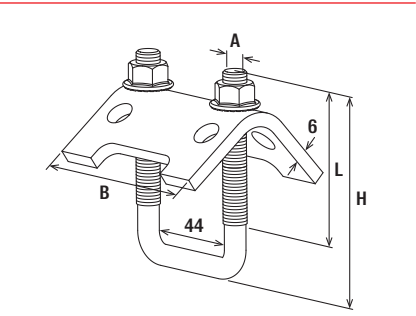

TKR

Technical data

		For profile	Sales unit
Item	Item no.		[pcs]
TKR 21-42 A4	559751	FUS 21 + FUS 21D + FUS 41	10
TKR 82 A4	562666	FUS 62 + FUS 41D	10

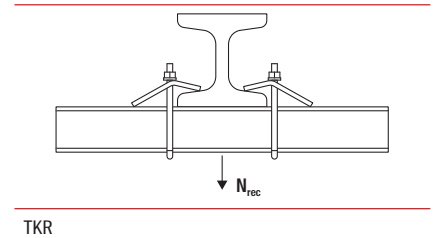

Loads

	Item no.	Max. recom. static load (centr. tension) N_{rec} [kN]	Tightening torque T_{inst} [Nm]	Max. clamping range girders [mm]	Sales unit [pcs]
Item					
TKR 21-42 A4	559751	10.00	20	25	10
TKR 82 A4	562666	10.00	20	25	10