

Beam clamp FMBC M12 and M16

Efficient connection of base plates to steel beams without welding and drilling



Fixing with beam clamp

Applications

- Simple fixing by clamping the base plate to the steel beams.
- For fixing FMSF S and FMSF BP S use FMBC M12. For FMS and FMSF BP M and L use FMBC M16.
- For indoor and outdoor application.

Advantages

- The design of the beam clamp FMBC M12 and M16 makes it possible to fix to steel beams without drilling or welding.
- The large clamping range of the FMBC M12 and M16 allows it to be attached to all common beam flanges.
- The design of the FMBC beam clamp M12 and M16 in the 3 matching bracket heights for the FMP massive profiles ensures fast mounting and easy moving of the profiles for adjustment.

Properties

- Material: cast iron with ductile iron QT450-10 (material no. 5.3107) acc. to EN 1563
- Zinc plating: hot-dip galvanised acc. to DIN EN ISO 1461
- Material screw: steel grade 8.8

Installation FMBC M

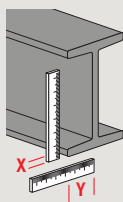

X = 3-36 mm
Y = 100-160 mm (FMBP S)
Y = 180-240 mm (FMBP M)
Y = 240-300 mm (FMBP L)

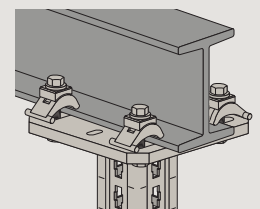
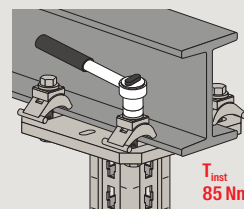
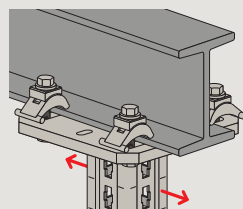
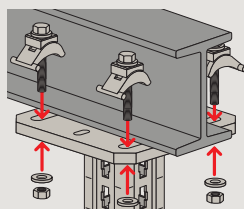

T_{inst}
85 Nm

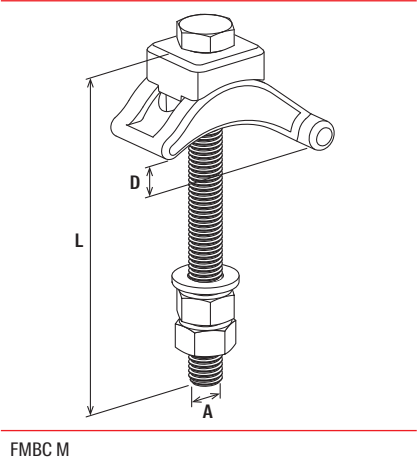

Technical data

		Thread	Length	Clamping range	Sales unit
	Item no.	A	L	D	
Item			[mm]	[mm]	[pcs]
FMBC M12	547839	M12	130	3 - 36	16
FMBC M16	547840	M16	150	3 - 36	12

11