

Air conditioner fixing KSU

The complete kit for fixing of Air conditioners, pumps or ventilators on walls



Air conditioning units

Applications

- Secure attachment of air conditioners, pumps and fans to walls with or without sound insulation element

Advantages

- The KSU Sets are available in two different versions: KSU without noise reduction dampers and the KSU S with noise reduction dampers.
- The horizontal cantilevers with different lengths and the sliding nut FCN Clix P 8 allow a flexible adjustment of the noise protection dampers to simplify the installation.
- The included sliding nut FCN Clix P 10 with screws for the fixing of the cantilevers offers the possibility of an easy adjustment and a time saving installation.
- The KSU set consists of finished cut channels for instant use and avoids the accumulation of single pieces.

Properties

- Material channels: steel S250GD+Z275 (material no. 1.0242)
- Material cantilever arms: steel S235JR (material no. 1.0037)
- Zinc plating channels: electro zinc-plated
- Zinc plating cantilever arms: electro zinc-plated

Installation KSU

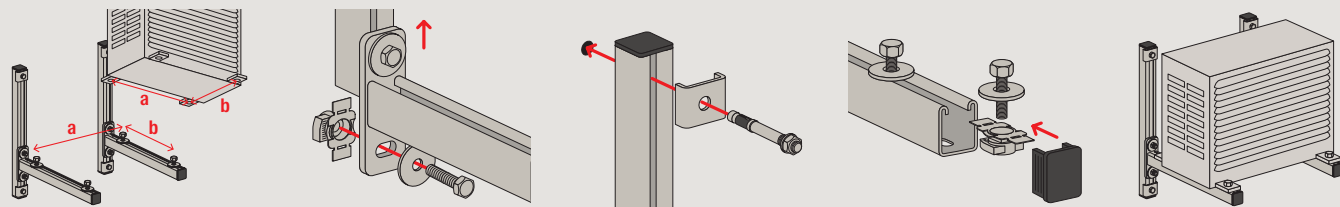

Installation KSU S

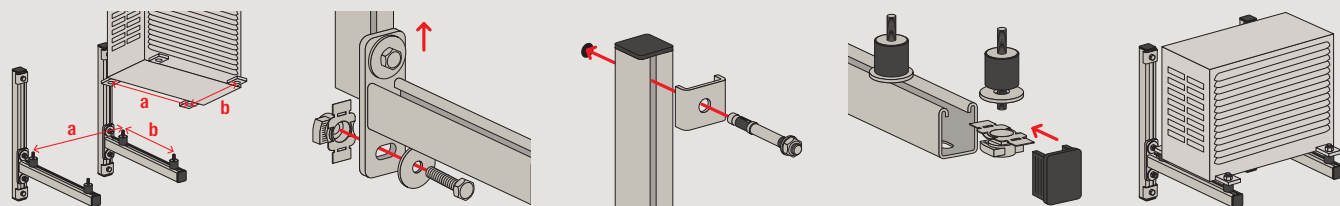

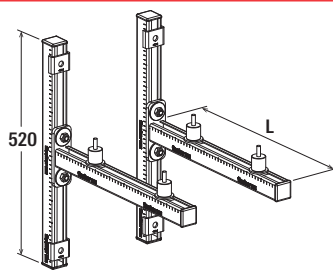

KSU

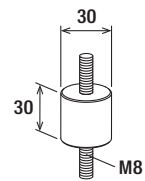

PA 30 x 30

Technical data

		Length	Construction with noise protection	Max. recommended static load load case 1	Max. recommended static load load case 2	Sales unit
Item	Item no.	L [mm]		F_{rec} [kN]	F_{rec} [kN]	[pcs]
KSU 450	553733	450	–	1.50	1.50	1
KSU 500	553734	500	–	1.50	1.50	1
KSU 600	553735	600	–	1.50	1.50	1
KSU S 450	553736	450	Yes	1.50	1.50	1
KSU S 500	553737	500	Yes	1.50	1.50	1
KSU S 600	553738	600	Yes	1.50	1.50	1
PA 30 x 30	512715	–	–	–	–	4

The loads are valid for the use in pairs (two consoles).

13

Load case 1

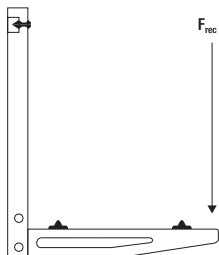

Load case 2

