



DEKLARACJA WŁAŚCIWOŚCI UŻYTKOWYCH

DoP 0238

dla systemu klejanego fischer FIS V Zero (Łączniki metalowe do stosowania w betonie)

PL

- Niepowtarzalny kod identyfikacyjny typu wyrobu: **DoP 0238**
- Zamierzone zastosowanie: **Mocowanie w betonie zarysowanym lub niezarysowanym, zobacz załącznik, w szczególności aneksy B1 - B10.**
- Producent: **fischerwerke GmbH & Co. KG, Otto-Hahn-Straße 15, 79211 Denzlingen, Niemcy**
- Upoważniony przedstawiciel: -
- System(-y) oceny i weryfikacji stałości właściwości użytkowych: **1**
- Europejski dokument oceny: **EAD 330499-01-0601, Edition 04/2020**
Europejska ocena techniczna: **ETA-20/0572; 2021-04-28**
Jednostka ds. oceny technicznej: **DIBt- Deutsches Institut für Bautechnik**
Jednostka lub jednostki notyfikowane: **2873 TU Darmstadt**
- Deklarowane właściwości użytkowe:
Wytrzymałość mechaniczna i stabilność osadzenia (BWR 1)
Nośność charakterystyczna na wrywanie (nośności statyczne i quasi-statyczne):
Nośność do uszkodzenia stali: Aneksy C1 - C3
Nośność na wrywanie i zniszczenie stożka betonu: Aneksy C4 - C7
Nośność do wyrwania stożka betonu: Aneks C4
Odległość od krawędzi zapobiegająca pękaniu pod obciążeniem: Aneks C4
Solidność: Aneksy C4 - C7
Maksymalny moment dokręcania: Aneksy B3, B4, B6
Minimalne odstępki osiowe i krawędziowe: Aneksy B3 - B6

Nośność charakterystyczna na ścinanie (nośności statyczne i quasi-statyczne):
Nośność do uszkodzenia stali: Aneksy C1 - C3
Nośność do uszkodzenia wyważenia: Aneks C4
Nośność do zniszczenia krawędzi betonu: Aneks C4

Nośność charakterystyczna i przemieszczenia w warunkach sejsmicznych dla kategorii C1 i C2:
Nośność na wrywanie, zmiany, kategoria C1: NPD
Nośność na wrywanie, zmiany kategoria C2: NPD
Nośność na ścinanie, zmiany, kategoria C1: NPD
Nośność na ścinanie, zmiany, kategoria C2: NPD
Współczynnik szczeliny pierścieniowej: NPD

Przemieszczenia pod obciążeniem krótko- i długoterminowym:
Przemieszczenia pod obciążeniem krótko- i długoterminowym: Aneksy C8, C9

Higiena, zdrowie i środowisko (BWR 3)
Treść, emisja i / lub uwalnianie substancji niebezpiecznych: NPD
- Odpowiednia dokumentacja techniczna lub specjalna dokumentacja techniczna: -

$E_s = 210\,000\text{ MPa}$
 $\tau_{Rk,100} = \text{NPD}$

Właściwości użytkowe określonego powyżej wyrobu są zgodne z zestawem deklarowanych właściwości użytkowych. Niniejsza deklaracja właściwości użytkowych wydana zostaje zgodnie z rozporządzeniem (UE) nr 305/2011 na wyłączną odpowiedzialność producenta określonego powyżej.

W imieniu producenta podpisał(-a):

Dr. Oliver Geibig, Dyrektor Zarządzający ds. Jednostek Biznesowych i Inżynierii
Tumlingen, 2021-05-12

Jürgen Grün, Dyrektor Zarządzający ds. Chemii i Jakości

Niniejsza Deklaracja Właściwości Użytkowych została przygotowana w różnych językach. W razie wątpliwości w interpretacji, wersja angielska jest zawsze miarodajna.

Załącznik zawiera dobrowolne i uzupełniające informacje w języku angielskim (neutralne językowo), a wykraczające poza wymagania prawne.

Specific Part

1 Technical description of the product

The Fischer injection system FIS V Zero is a bonded fastener consisting of an injection cartridge with injection mortar FIS V Zero and a steel element according to Annex A.

The steel element is placed into a drilled hole filled with injection mortar and is anchored via the bond between metal part, injection mortar and concrete.

The product description is given in Annex A.

2 Specification of the intended use in accordance with the applicable European Assessment Document

The performances given in Section 3 are only valid if the anchor is used in compliance with the specifications and conditions given in Annex B.

The verifications and assessment methods on which this European Technical Assessment is based lead to the assumption of a working life of the anchor of at least 50 years. The indications given on the working life cannot be interpreted as a guarantee given by the producer, but are to be regarded only as a means for choosing the right products in relation to the expected economically reasonable working life of the works.

3 Performance of the product and references to the methods used for its assessment

3.1 Mechanical resistance and stability (BWR 1)

| Essential characteristic | Performance |
|--|----------------------------------|
| Characteristic resistance to tension load (static and quasi-static loading) | See Annex C 1 to C 7, B 3 to B 6 |
| Characteristic resistance to shear load (static and quasi-static loading) | See Annex C 1 to C 4 |
| Displacements under short-term and long-term loading | See Annex C 8 to C 9 |
| Characteristic resistance and displacements for seismic performance categories C1 and C2 | No performance assessed |

3.2 Hygiene, health and the environment (BWR 3)

| Essential characteristic | Performance |
|--|-------------------------|
| Content, emission and/or release of dangerous substances | No performance assessed |

4 Assessment and verification of constancy of performance (AVCP) system applied, with reference to its legal base

In accordance with the European Assessment Document EAD 330499-01-0601 the applicable European legal act is: [96/582/EC].

The system to be applied is: 1

Installation conditions part 1

fischer anchor rod

Pre-positioned installation

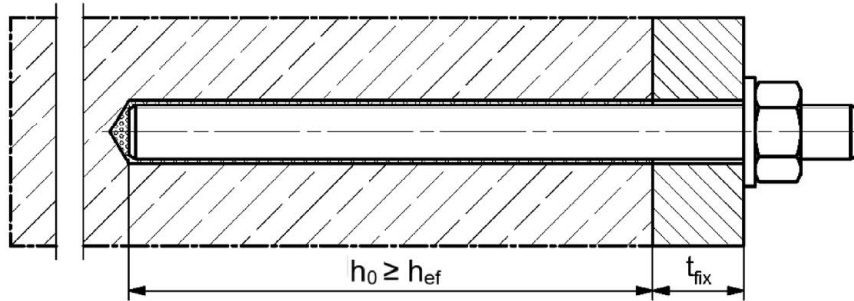

Push through installation (annular gap filled with mortar)

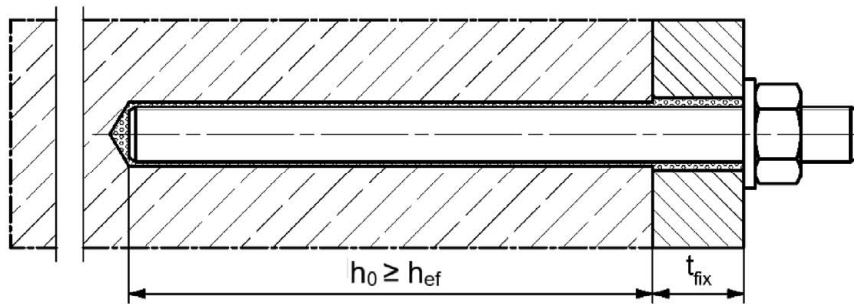

Pre-positioned or push through installation with subsequently injected fischer filling disc (annular gap filled with mortar)

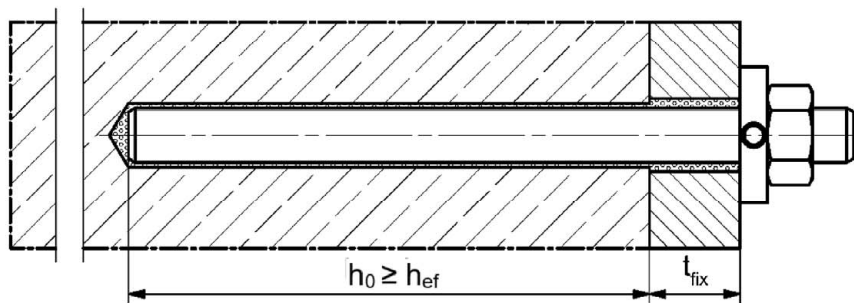

Figures not to scale

h_0 = drill hole depth

h_{ef} = effective embedment depth

t_{fix} = thickness of fixture

fischer injection system FIS V Zero

Product description
Installation conditions part 1

Annex A 1

Appendix 2 / 26

Installation conditions part 2

fischer internal threaded anchor RG M I

Pre-positioned installation

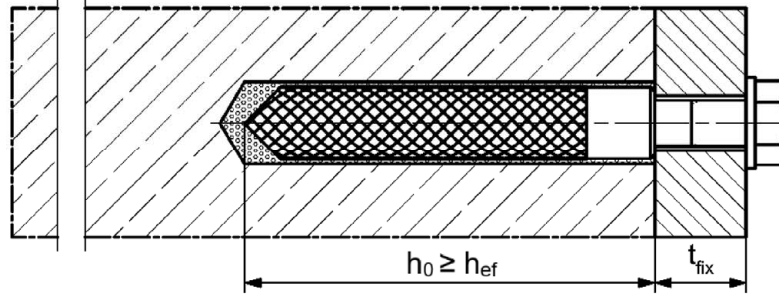

Pre-positioned installation with subsequently injected fischer filling disc (annular gap filled with mortar)

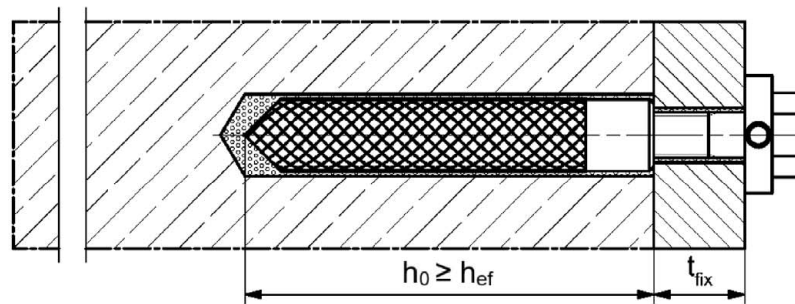

Figures not to scale

h_0 = drill hole depth

h_{ef} = effective embedment depth

t_{fix} = thickness of fixture

fischer injection system FIS V Zero

Product description
Installation conditions part 2

Annex A 2

Appendix 3 / 26

Installation conditions part 3

Reinforcing bar

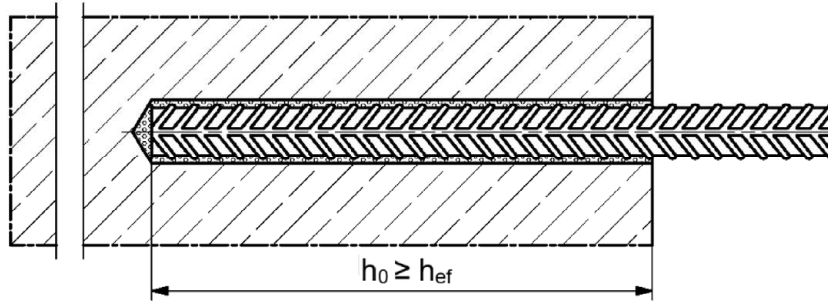

fischer rebar anchor FRA

Pre-positioned installation

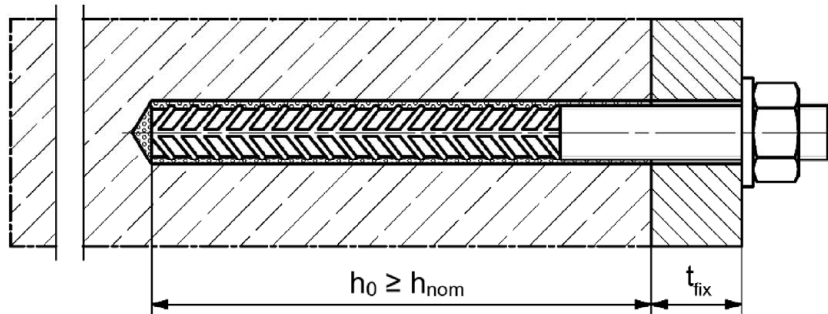

Push through installation (annular gap filled with mortar)

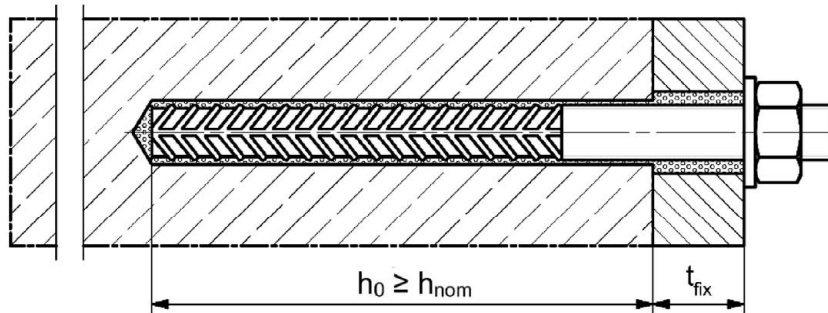

Figures not to scale

h_0 = drill hole depth

h_{ef} = effective embedment depth

t_{fix} = thickness of fixture

h_{nom} = overall fastener embedment depth in the concrete

fischer injection system FIS V Zero

Product description
Installation conditions part 3

Annex A 3

Appendix 4 / 26

Overview system components part 1

Injection cartridge (shuttle cartridge) with sealing cap; Sizes: 360 ml, 825 ml

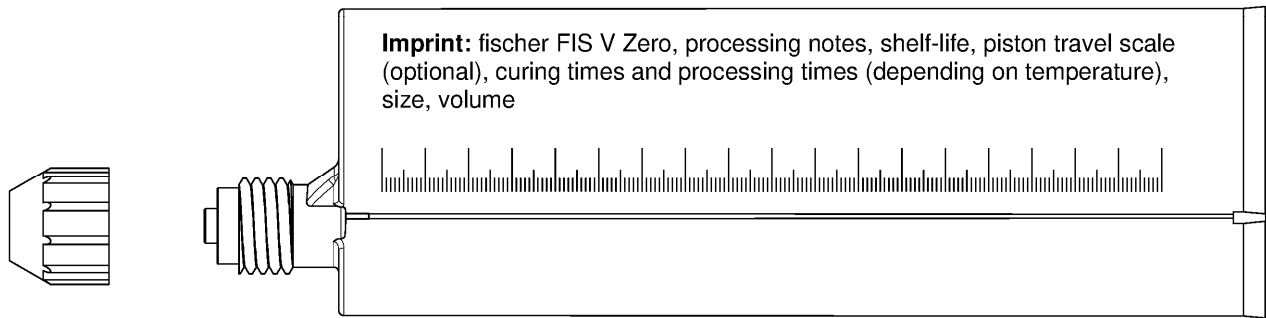

Injection cartridge (coaxial cartridge) with sealing cap; Sizes: 100 ml, 150 ml, 300 ml, 380 ml, 400 ml, 410 ml

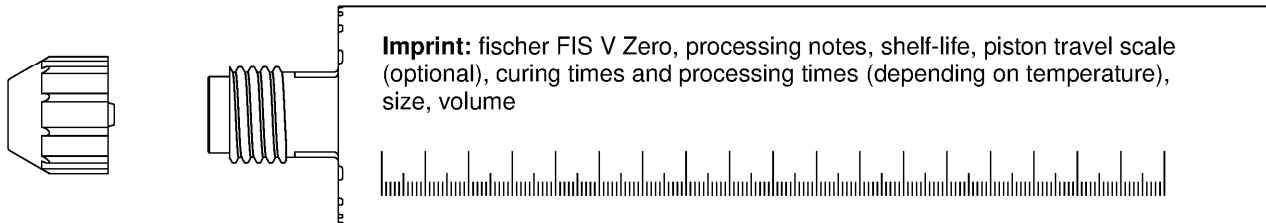

Static mixer FIS MR Plus for injection cartridges up to 410 ml

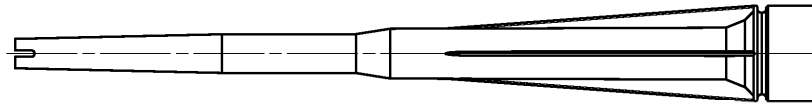

Static mixer FIS JMR for injection cartridges 825 ml

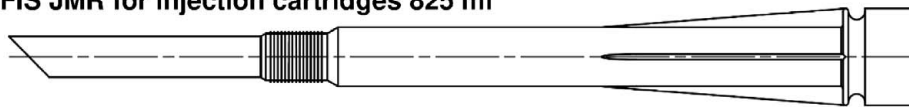

Injection adapter and extension tube Ø 9 for static mixer FIS MR Plus; Injection adapter and extension tube Ø 9 or Ø 15 for static mixer FIS JMR

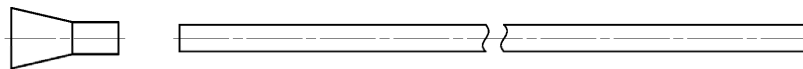

Cleaning brush BS



Blow-out pump

AB G



ABP:



Figures not to scale

fischer injection system FIS V Zero

Product description

Overview system components part 1;
cartridges / static mixer / accessories

Annex A 4

Appendix 5 / 26

Overview system components part 2

fischer anchor rod

Size: M8, M10, M12, M16, M20, M24

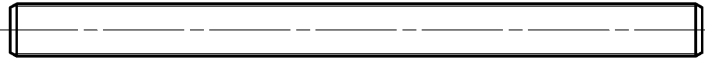

fischer internal threaded anchor RG M I

Size: M8, M10, M12, M16



Screw / threaded rod / washer / hexagon nut

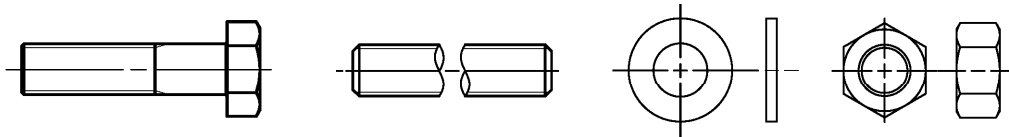

fischer filling disc with injection adapter

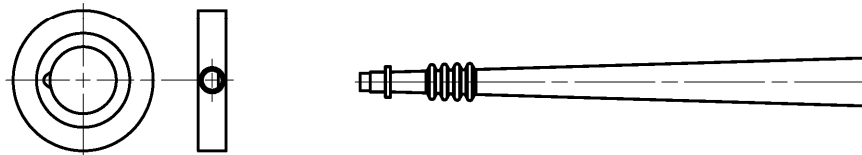

Reinforcing bar

Nominal diameter: $\phi 8$, $\phi 10$, $\phi 12$, $\phi 14$, $\phi 16$, $\phi 20$, $\phi 22$, $\phi 24$, $\phi 25$



fischer rebar anchor FRA

Size: M12, M16, M20, M24



Figures not to scale

fischer injection system FIS V Zero

Product description

Overview system components part 2;
steel components, injection adapter

Annex A 5

Appendix 6 / 26

Table A6.1: Materials

| Part | Designation | Material | | |
|------|---|--|---|--|
| 1 | Injection cartridge | Mortar, hardener, filler | | |
| | Steel grade | Steel | Stainless steel R | High corrosion resistant steel HCR |
| | | zinc plated | acc. to EN 10088-1:2014 Corrosion resistance class CRC III acc. to EN 1993-1-4:2015 | acc. to EN 10088-1:2014 Corrosion resistance class CRC V acc. to EN 1993-1-4:2015 |
| 2 | Anchor rod | Property class 4.8, 5.8 or 8.8; EN ISO 898-1:2013 zinc plated $\geq 5 \mu\text{m}$, ISO 4042:2018/Zn5/An(A2K) or hot dip galvanised $\geq 40 \mu\text{m}$ EN ISO 10684:2004 $f_{uk} \leq 1000 \text{ N/mm}^2$ $A_5 > 8\%$ fracture elongation | Property class 50, 70 or 80 EN ISO 3506-1:2009 1.4401; 1.4404; 1.4578; 1.4571; 1.4439; 1.4362; 1.4062, 1.4662, 1.4462; EN 10088-1:2014 $f_{uk} \leq 1000 \text{ N/mm}^2$ $A_5 > 8\%$ fracture elongation | Property class 50 or 80 EN ISO 3506-1:2009 or property class 70 with $f_{yk} = 560 \text{ N/mm}^2$ 1.4565; 1.4529; EN 10088-1:2014 $f_{uk} \leq 1000 \text{ N/mm}^2$ $A_5 > 8\%$ fracture elongation |
| 3 | Washer ISO 7089:2000 | zinc plated $\geq 5 \mu\text{m}$, ISO 4042:2018/Zn5/An(A2K) or hot dip galvanised $\geq 40 \mu\text{m}$ EN ISO 10684:2004 | 1.4401; 1.4404; 1.4578; 1.4571; 1.4439; 1.4362; EN 10088-1:2014 | 1.4565; 1.4529; EN 10088-1:2014 |
| 4 | Hexagon nut | Property class 4, 5 or 8; EN ISO 898-2:2012 zinc plated $\geq 5 \mu\text{m}$, ISO 4042:2018/Zn5/An(A2K) or hot dip galvanised $\geq 40 \mu\text{m}$ EN ISO 10684:2004 | Property class 50, 70 or 80 EN ISO 3506-1:2009 1.4401; 1.4404; 1.4578; 1.4571; 1.4439; 1.4362; EN 10088-1:2014 | Property class 50, 70 or 80 EN ISO 3506-1:2009 1.4565; 1.4529; EN 10088-1:2014 |
| 5 | fischer internal threaded anchor RG M I | Property class 5.8 ISO 898-1:2013 zinc plated $\geq 5 \mu\text{m}$, ISO 4042:2018/Zn5/An(A2K) | Property class 70 EN ISO 3506-1:2009 1.4401; 1.4404; 1.4578; 1.4571; 1.4439; 1.4362; EN 10088-1:2014 | Property class 70 EN ISO 3506-1:2009 1.4565; 1.4529; EN 10088-1:2014 |
| 6 | Commercial standard screw or threaded rod for fischer internal threaded anchor RG M I | Property class 5.8 or 8.8; EN ISO 898-1:2013 zinc plated $\geq 5 \mu\text{m}$, ISO 4042:2018/Zn5/An(A2K) $A_5 > 8\%$ fracture elongation | Property class 70 EN ISO 3506-1:2009 1.4401; 1.4404; 1.4578; 1.4571; 1.4439; 1.4362; EN 10088-1:2014 $A_5 > 8\%$ fracture elongation | Property class 70 EN ISO 3506-1:2009 1.4565; 1.4529; EN 10088-1:2014 $A_5 > 8\%$ fracture elongation |
| 7 | fischer filling disc similar to DIN 6319-G | zinc plated $\geq 5 \mu\text{m}$, ISO 4042:2018/Zn5/An(A2K) or hot dip galvanised $\geq 40 \mu\text{m}$ EN ISO 10684:2004 | 1.4401; 1.4404; 1.4578; 1.4571; 1.4439; 1.4362; EN 10088-1:2014 | 1.4565; 1.4529; EN 10088-1:2014 |
| 8 | Reinforcing bar EN 1992-1-1:2004 and AC:2010, Annex C | Bars and de-coiled rods, class B or C with f_{yk} and k according to NDP or NCL of according to EN 1992-1-1/NA $f_{uk} = f_{tk} = k \cdot f_{yk} (A_5 > 8\%)$ | | |
| 9 | fischer rebar anchor FRA | Rebar part: Bars and de-coiled rods class B or C with f_{yk} and k according to NDP or NCL of EN 1992-1-1:2004+AC:2010 $f_{uk} = f_{tk} = k \cdot f_{yk}$ | Threaded part: Property class 70 or for M24 PC 80, EN ISO 3506-1:2009 1.4401, 1.4404, 1.4571, 1.4578, 1.4439, 1.4362, 1.4062 acc. to EN 10088-1:2014 Corrosion resistance class CRC III acc. to EN 1993-1-4:2015 1.4565; 1.4529 acc. to EN 10088-1:2014 Corrosion resistance class CRC V acc. to EN 1993-1-4:2015 | |

fischer injection system FIS V Zero







Product description
Materials

Annex A 6

Appendix 7 / 26

Specifications of intended use (part 1)

Table B1.1: Overview use and performance categories

| | | FIS V Zero with ... | | | | | | | |
|--|------------------------------------|--|--|--|--|-----------|---|-------------------------------------|---|
| | | Anchor rod  | fischer internal threaded anchor RG M I  | Reinforcing bar  | fischer rebar anchor FRA  | | | | |
| Hammer drilling with standard drill bit  | | all sizes | | | | | | | |
| Hammer drilling with hollow drill bit (fischer „FHD“, Heller „Duster Expert“; Bosch „Speed Clean“; Hilti „TE-CD, TE-YD“)  | | Nominal drill bit diameter (d ₀) 12 mm to 30 mm | | | | | | | |
| Static and quasi static load, in | uncracked concrete | all sizes | Tables: C1.1 C4.1 C5.1 C8.1 | all sizes | Tables: C2.1 C4.1 C6.1 C8.2 | all sizes | Tables: C3.1 C4.1 C7.1 C9.1 | all sizes | Tables: C3.2 C4.1 C7.2 C9.2 |
| | cracked concrete ²⁾ | all sizes | | all sizes | | -1) | | all sizes | -1) |
| Seismic performance category | C1 ¹⁾ | -1) | | -1) | | -1) | | -1) | |
| | C2 ¹⁾ | | | | | | | | |
| Use conditions | I1 dry or wet concrete | all sizes | | all sizes | | all sizes | | all sizes | |
| | I2 water filled hole ²⁾ | all sizes | | all sizes | | all sizes | | all sizes | |
| Installation direction | | D3 (downward and horizontal and upwards (e.g. overhead) installation) | | | | | | | |
| Installation temperature | | T _{i,min} = -10 °C to T _{i,max} = +40 °C for the standard variation of temperature after installation | | | | | | | |
| In-service temperature | Temperature range I | -40 °C to +40 °C | | (max. short term temperature +40 °C; max. long term temperature +24 °C) | | | | | |
| | Temperature range II | -40 °C to +80 °C | | (max. short term temperature +80 °C; max. long term temperature +50 °C) | | | | | |
| | Temperature range III | -40 °C to +120 °C | | (max. short term temperature +120 °C; max. long term temperature +72 °C) | | | | | |
| ¹⁾ No performance assessed ²⁾ No performance assessed for installation with hollow drill bit in cracked concrete or water filled hole | | | | | | | | | |
| fischer injection system FIS V Zero | | | | | | | | Annex B 1 Appendix 8 / 26 | |
| Intended use Specifications (part 1) | | | | | | | | | |

Specifications of intended use (part 2)

Base materials:

- Compacted reinforced or unreinforced normal weight concrete without fibres of strength classes C20/25 to C50/60 according to EN 206:2013+A1:2016

Use conditions (Environmental conditions):

- Structures subject to dry internal conditions (zinc plated steel, stainless steel or high corrosion resistant steel).
- For all other conditions according to EN 1993-1-4:2015 corresponding to corrosion resistance classes to Annex A 6 table A6.1.

Design:

- Anchorages have to be designed by a responsible engineer with experience of concrete anchor design.
- Verifiable calculation notes and drawings are to be prepared taking account of the loads to be anchored. The position of the anchor is indicated on the design drawings (e. g. position of the anchor relative to reinforcement or to supports, etc.).
- Anchorages are designed in accordance with: EN 1992-4:2018 and EOTA Technical Report TR 055, Edition February 2018.

Installation:

- Anchor installation is to be carried out by appropriately qualified personnel and under the supervision of the person responsible for technical matters of the site
- In case of aborted hole: The hole shall be filled with mortar
- Anchorage depth should be marked and adhered to installation
- Overhead installation is allowed (necessary equipment see installation instruction)

fischer injection system FIS V Zero

Intended use
Specifications (part 2)

Annex B 2

Appendix 9 / 26

Table B3.1: Installation parameters for **anchor rods**

| Anchor rods | | Thread | M8 | M10 | M12 | M16 | M20 | M24 |
|---|--------------------------------------|--------|--------------------------|-----|-----|-----------------|-----|-----|
| Width across flats | SW | [mm] | 13 | 17 | 19 | 24 | 30 | 36 |
| Nominal drill hole diameter | d_0 | | 10 | 12 | 14 | 18 | 22 | 28 |
| Drill hole depth | h_0 | | $h_0 = h_{ef}$ | | | | | |
| Effective embedment depth | $h_{ef, min}$ | | 60 | 60 | 70 | 80 | 90 | 96 |
| | $h_{ef, max}$ | | 160 | 200 | 240 | 320 | 400 | 480 |
| Minimum spacing and minimum edge distance | $S_{min} = C_{min}$ | | 40 | 45 | 55 | 65 | 85 | 105 |
| | | | | | | | | |
| Diameter of the clearance hole of the fixture | pre-positioned installation d_f | | 9 | 12 | 14 | 18 | 22 | 26 |
| | push through installation d_f | | 12 | 14 | 16 | 20 | 24 | 30 |
| Minimum thickness of concrete member | h_{min} | | $h_{ef} + 30 (\geq 100)$ | | | $h_{ef} + 2d_0$ | | |
| Maximum installation torque | $\max T_{inst}$ | [Nm] | 10 | 20 | 40 | 60 | 120 | 150 |

fischer anchor rod

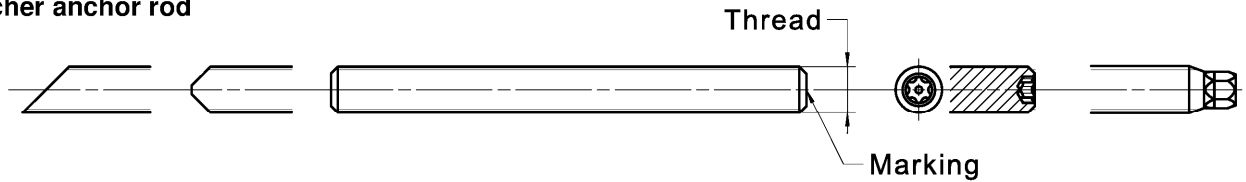

Marking (on random place) fischer anchor rod:

| | | | |
|--|--------|--|---|
| Steel zinc plated PC ¹⁾ 8.8 | • or + | Steel hot-dip PC ¹⁾ 8.8 | • |
| High corrosion resistant steel HCR PC ¹⁾ 50 | • | High corrosion resistant steel HCR PC ¹⁾ 70 | - |
| High corrosion resistant steel HCR PC ¹⁾ 80 | (| Stainless steel R property class 50 | ~ |
| Stainless steel R property class 80 | * | | |

Alternatively: Colour coding according to DIN 976-1: 2016

¹⁾ PC = property class

Installation conditions:

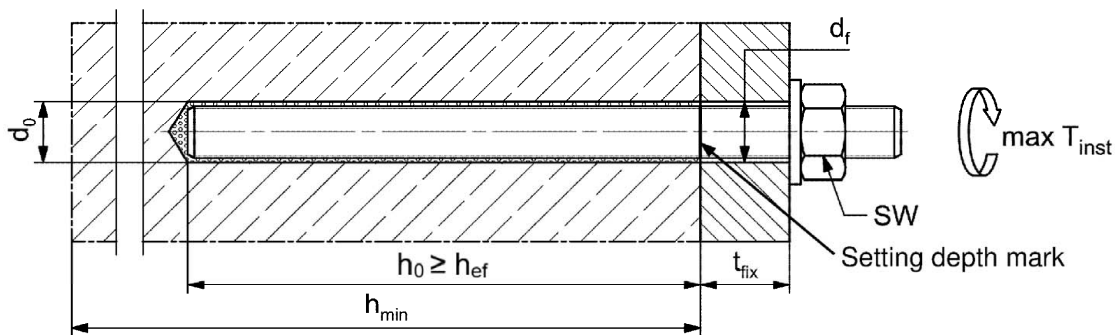

Commercial standard threaded rods, washers and hexagon nuts may also be used, if the following requirements are fulfilled:

- Materials, dimensions and mechanical properties according to Annex A 6, Table A6.1
- Inspection certificate 3.1 according to EN 10204:2004, the documents have to be stored
- Setting depth is marked

Figures not to scale

fischer injection system FIS V Zero

Intended use
Installation parameters anchor rods

Annex B 3

Appendix 10 / 26

Table B4.1: Installation parameters for **fischer internal threaded anchors RG M I**

| Internal threaded anchors RG M I | | Thread | M8 | M10 | M12 | M16 |
|---|-----------------------------|--------|----------------------|-----|-----|-----|
| Diameter of anchor | $d_{nom} = d_H$ | [mm] | 12 | 16 | 18 | 22 |
| Nominal drill hole diameter | d_0 | | 14 | 18 | 20 | 24 |
| Drill hole depth | h_0 | | $h_0 = h_{ef} = L_H$ | | | |
| Effective embedment depth ($h_{ef} = L_H$) | h_{ef} | | 90 | 90 | 125 | 160 |
| Minimum spacing and minimum edge distance | s_{min} = c_{min} | | 55 | 65 | 75 | 95 |
| Diameter of clearance hole in the fixture | d_f | | 9 | 12 | 14 | 18 |
| Minimum thickness of concrete member | h_{min} | | 120 | 125 | 165 | 205 |
| Maximum screw-in depth | $l_{E,max}$ | | 18 | 23 | 26 | 35 |
| Minimum screw-in depth | $l_{E,min}$ | | 8 | 10 | 12 | 16 |
| Maximum installation torque | $\max T_{inst}$ | [Nm] | 10 | 20 | 40 | 80 |

fischer internal threaded anchor RG M I

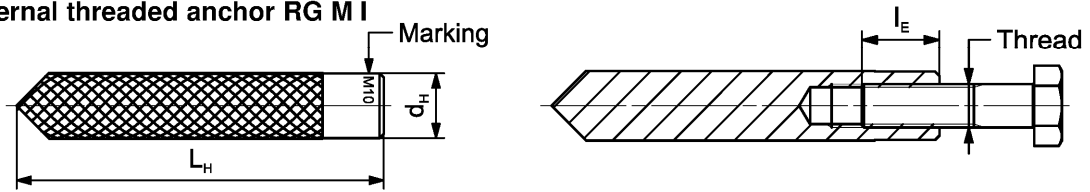

Marking: Anchor size e. g.: **M10**
 Stainless steel → additional **R**; e.g.: **M10 R**
 High corrosion resistant steel → additional **HCR**; e.g.: **M10 HCR**

Retaining bolt or threaded rods (including nut and washer) must comply with the appropriate material and strength class of Annex A 6, Table A6.1

Installation conditions:

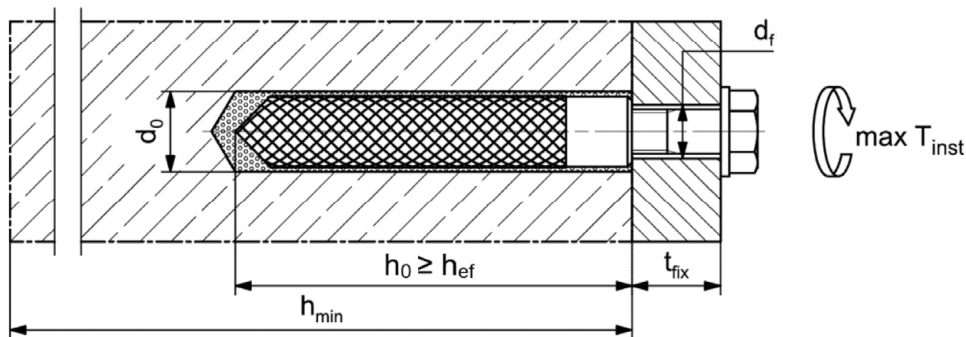

Figures not to scale

fischer injection system FIS V Zero

Intended use
 Installation parameters internal threaded anchors RG M I

Annex B 4

Appendix 11 / 26

Table B5.1: Installation parameters for reinforcing bars

| Nominal diameter of the bar | | ϕ | 8 ¹⁾ | | 10 ¹⁾ | | 12 ¹⁾ | | 14 | 16 | 20 | 22 | 24 | 25 |
|---|---------------------|---------------------------------|-----------------|-----|------------------|-----|------------------|-----|-----|-----|-----|----|----|----|
| Nominal drill hole diameter | d_0 | [mm] | 10 | 12 | 12 | 14 | 14 | 16 | 18 | 20 | 25 | 28 | 30 | 30 |
| Drill hole depth | h_0 | | $h_0 = h_{ef}$ | | | | | | | | | | | |
| Effective embedment depth | $h_{ef,min}$ | | 60 | 60 | 70 | 75 | 80 | 90 | 94 | 98 | 100 | | | |
| | $h_{ef,max}$ | | 160 | 200 | 240 | 280 | 320 | 400 | 440 | 480 | 500 | | | |
| Minimum spacing and minimum edge distance | $s_{min} = c_{min}$ | | 40 | 45 | 55 | 60 | 65 | 85 | 95 | 105 | 110 | | | |
| Minimum thickness of concrete member | h_{min} | $h_{ef} + 30$ (≥ 100) | | | $h_{ef} + 2d_0$ | | | | | | | | | |

1) Both drill hole diameters can be used

Reinforcing bar



- The minimum value of related rib area $f_{R,min}$ must fulfil the requirements of EN 1992-1-1:2004+AC:2010
- The rib height must be within the range: $0,05 \cdot \phi \leq h_{rib} \leq 0,07 \cdot \phi$
(ϕ = Nominal diameter of the bar, h_{rib} = rib height)

Installation conditions:

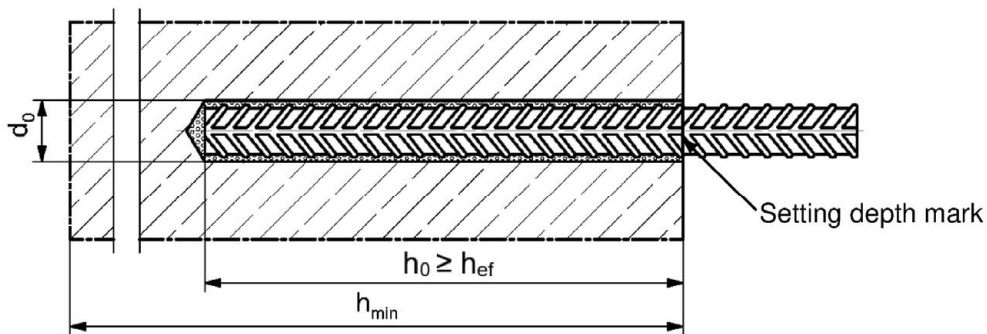

Figures not to scale

fischer injection system FIS V Zero

Intended use
Installation parameters reinforcing bars

Annex B 5

Appendix 12 / 26

Table B6.1: Installation parameters for **fischer rebar anchor FRA**

| Rebar anchor FRA | | Thread | M12 ¹⁾ | M16 | M20 | M24 |
|---|-------------------------------------|------------|-------------------|-----|-----|-----|
| Nominal diameter of the bar | ϕ | [mm] | 12 | 16 | 20 | 25 |
| Width across flats | SW | | 19 | 24 | 30 | 36 |
| Nominal drill hole diameter | d_0 | | 14 | 16 | 20 | 30 |
| Drill hole depth | h_0 | | $h_{ef} + l_e$ | | | |
| Effective embedment depth | $h_{ef,min}$ | | 70 | 80 | 90 | 96 |
| | $h_{ef,max}$ | | 140 | 220 | 300 | 380 |
| Distance concrete surface to welded joint | l_e | | 100 | | | |
| Minimum spacing and minimum edge distance | $s_{min} = c_{min}$ | | 55 | 65 | 85 | 105 |
| Diameter of clearance hole in the fixture | pre-positioned anchorage $\leq d_f$ | | 14 | 18 | 22 | 26 |
| | push through anchorage $\leq d_f$ | | 18 | 22 | 26 | 32 |
| Minimum thickness of concrete member | h_{min} | $h_0 + 30$ | $h_0 + 2d_0$ | | | |
| Maximum installation torque | $\max T_{inst}$ | [Nm] | 40 | 60 | 120 | 150 |

¹⁾ Both drill hole diameters can be used

fischer rebar anchor FRA

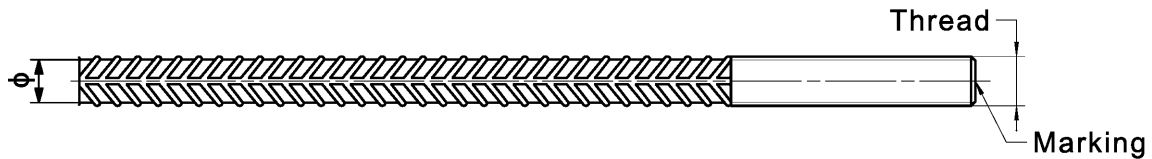

Marking frontal e.g:

- FRA (for stainless steel);
- FRA HCR (for high corrosion resistant steel)

Installation conditions:

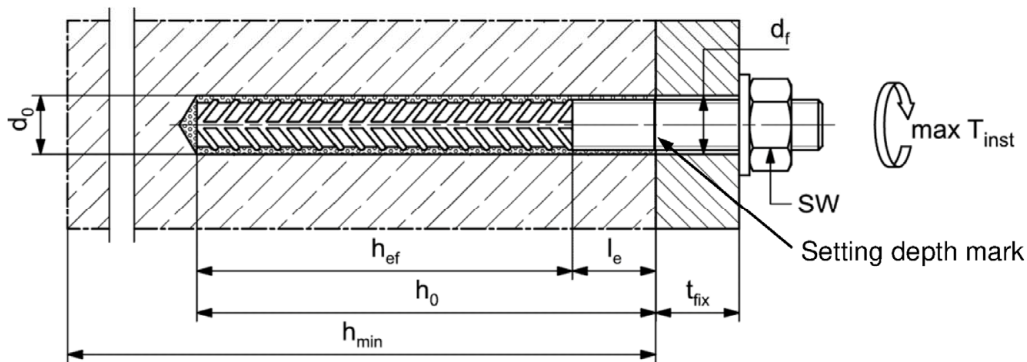

Figures not to scale

fischer injection system FIS V Zero

Intended use
Installation parameters fischer rebar anchor FRA

Annex B 6

Appendix 13 / 26

Table B7.1: Parameters of the **cleaning brush BS** (steel brush with steel bristles)

The size of the cleaning brush refers to the drill hole diameter

| | | | | | | | | | | | | | |
|-----------------------------|-------|------|----|----|----|----|----|----|----|----|----|----|----|
| Nominal drill hole diameter | d_0 | [mm] | 10 | 12 | 14 | 16 | 18 | 20 | 22 | 24 | 25 | 28 | 30 |
| Steel brush diameter | d_b | | 11 | 14 | 16 | 20 | | 25 | | 26 | 27 | 30 | 40 |

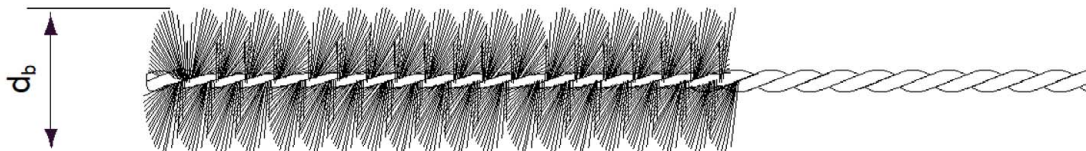
**Table B7.2:** Conditions for use **static mixer** without an **extension tube**

| | | | | | | | | | | | | | |
|---------------------------------|-------------|------|-----|----|------|------|------|------|------|------|------|------|----|
| Nominal drill hole diameter | d_0 | [mm] | 10 | 12 | 14 | 16 | 18 | 20 | 22 | 24 | 25 | 28 | 30 |
| Drill hole depth h_0 by using | FIS MR Plus | [mm] | ≤90 | | ≤120 | ≤140 | ≤150 | ≤160 | ≤170 | ≤190 | ≤210 | | |
| | FIS JMR | | - | - | ≤90 | ≤160 | ≤180 | ≤190 | ≤210 | ≤220 | | ≤250 | |

Table B7.3 **Maximum processing** time of the mortar and **minimum curing** time (During the curing time of the mortar the concrete temperature may not fall below the listed minimum temperature)

| Temperature at anchoring base [°C] | Maximum processing time t_{work} | Minimum curing time ¹⁾ t_{cure} |
|------------------------------------|------------------------------------|--|
| | FIS V Zero | FIS V Zero |
| -10 to -5 ²⁾ | 6 h | 72 h |
| > -5 to 0 ²⁾ | 2 h | 24 h |
| > 0 to 5 ²⁾ | 45 min | 12 h |
| > 5 to 10 | 20 min | 6 h |
| > 10 to 15 | 8 min | 3 h |
| > 15 to 20 | 5 min | 2 h |
| > 20 to 25 | 3 min | 1 h |
| > 25 to 30 | 2 min | 45 min |
| > 30 to 40 | 1 min | 30 min |

¹⁾ In wet concrete or water filled holes the curing times must be doubled²⁾ Minimum cartridge temperature +5°C

fischer injection system FIS V Zero

Intended use
 Cleaning brush (steel brush)
 Processing time and curing time

Annex B 7

Appendix 14 / 26

Installation instructions part 1

Drilling and cleaning the hole (hammer drilling with standard drill bit)

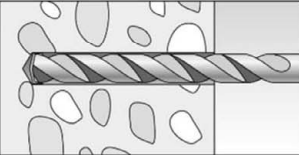
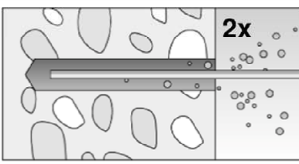
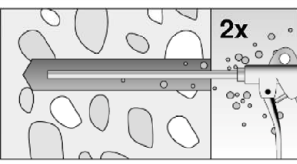
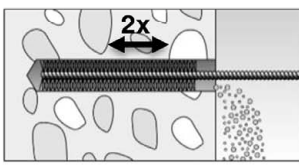
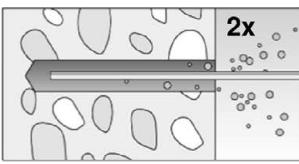
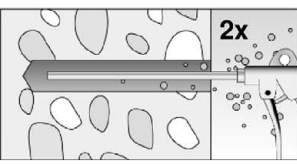
| | | |
|---|---|--|
| 1 |  | <p>Drill the hole. Nominal drill hole diameter d_0 and drill hole depth h_0 see tables B3.1, B4.1, B5.1, B6.1</p> |
| 2 |  <p>2x</p> |  <p>2x</p> <p>For $h_{ef} > 12d$ and / or $d_0 \geq 18$ mm blow out the hole twice with oil-free compressed air ($p \geq 6$ bar)</p> |
| 3 |  <p>2x</p> | <p>Brush the drill hole twice. For drill hole diameter $d_0 \geq 18$ mm and / or $h_{ef} > 12d$ use a power drill. For deep holes use an extension. Corresponding brushes see table B7.1</p> |
| 4 |  <p>2x</p> |  <p>2x</p> <p>For $h_{ef} > 12d$ and / or $d_0 \geq 18$ mm blow out the hole twice with oil-free compressed air ($p \geq 6$ bar)</p> |

Go to step 5

Drilling and cleaning the hole (hammer drilling with hollow drill bit)

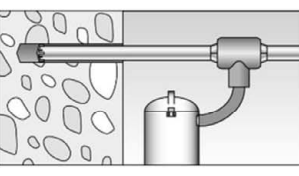
| | | |
|---|---|--|
| 1 |  | <p>Check a suitable hollow drill (see table B1.1) for correct operation of the dust extraction</p> |
| 2 |  | <p>Use a suitable dust extraction system, e.g. fischer FVC 35 M or a comparable dust extraction system with equivalent performance data</p> <p>Drill the hole with hollow drill bit. The dust extraction system has to extract the drill dust nonstop during the drilling process and must be adjusted to maximum power. Nominal drill hole diameter d_0 and drill hole depth h_0 see tables B3.1, B4.1, B5.1, B6.1</p> |

Go to step 5

fischer injection system FIS V Zero



Intended use
Installation instructions part 1

Annex B 8

Appendix 15 / 26

Installation instructions part 2

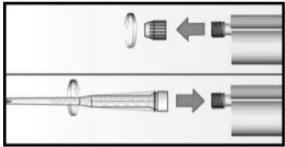
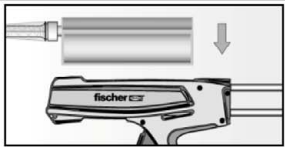
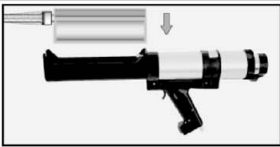
Preparing the cartridge

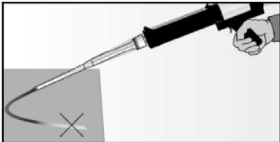
| | | | |
|---|---|---|---|
| 5 |  | <p>Remove the sealing cap</p> <p>Screw on the static mixer (the spiral in the static mixer must be clearly visible)</p> | |
| 6 |  |  | <p>Place the cartridge into the dispenser</p> |
| 7 |  |  | <p>Extrude approximately 10 cm of material out until the resin is evenly grey in colour. Do not use mortar that is not uniformly grey</p> |

Go to step 8

Injection of the mortar

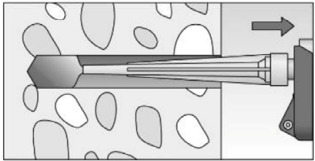
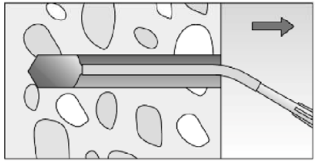
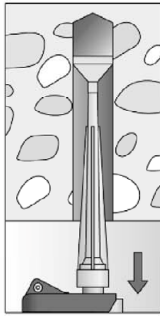
| | | | |
|---|---|---|--|
| 8 |  |  |  |
| | <p>Fill approximately 2/3 of the drill hole with mortar. Always begin from the bottom of the hole and avoid bubbles</p> | <p>The conditions for mortar injection without extension tube can be found in table B7.2</p> <p>For deeper drill holes, than those mentioned in table B7.2, use a suitable extension tube</p> | <p>For overhead installation, deep holes ($h_0 > 250$ mm) or drill hole diameter ($d_0 = 30$ mm) use an injection adapter</p> |

Go to step 9

fischer injection system FIS V Zero



Intended use
Installation instructions part 2

Annex B 9

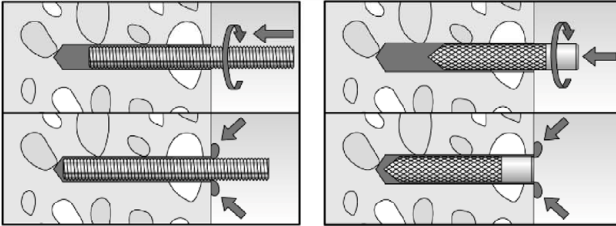
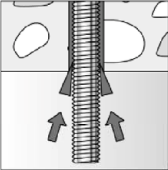
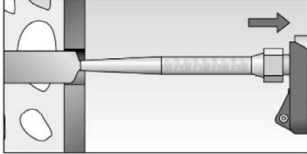

Appendix 16 / 26

Installation instructions part 3

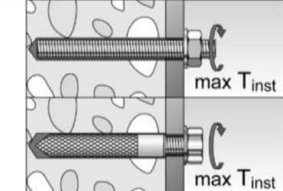
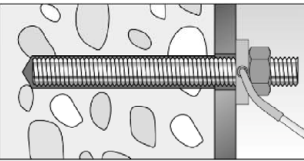
Installation of anchor rods or fischer internal threaded anchors RG M I

| | | |
|--------|---|---|
| 9 |  | <p>Only use clean and oil-free metal parts. Mark the setting depth of the metal part. Push the anchor rod or fischer internal threaded RG M I anchor down to the bottom of the hole, turning it slightly while doing so. After inserting the metal parts, excess mortar must be emerged around the anchor element.</p> |
| |  <p>For overhead installations support the metal part with wedges (e.g. fischer centering wedges) or fischer overhead clips.</p> |  <p>For push through installation fill the annular gap with mortar</p> |
| 10 |  <p>Wait for the specified curing time t_{cure} see table B7.3</p> |  <p>Mounting the fixture max T_{inst} see tables B3.1 and B4.1</p> |
| Option |  | <p>After the minimum curing time is reached, the gap between metal part and fixture (annular clearance) may be filled with mortar via the fischer filling disc. Compressive strength $\geq 50 \text{ N/mm}^2$ (e.g. fischer injection mortars FIS V Zero, FIS HB, FIS SB, FIS V, FIS V Plus, FIS EM Plus). ATTENTION: Using fischer filling disc reduces t_{fix} (usable length of the anchor)</p> |

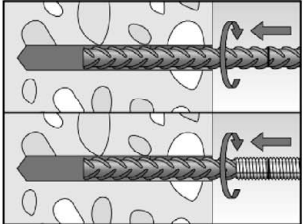
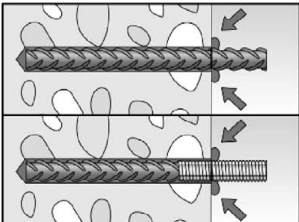
Installation reinforcing bars and fischer rebar anchor FRA

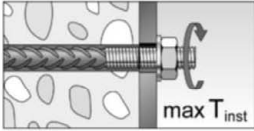
| | | |
|----|---|--|
| 9 |  | <p>Only use clean and oil-free reinforcing bars or fischer rebar anchor FRA. Mark the setting depth. Push the reinforcement bar or the fischer rebar anchor FRA into the filled hole up to the setting depth mark. Recommendation: Rotation back and forth of the reinforcement bar or the fischer rebar anchor FRA makes pushing easy</p> |
| |  | <p>When the setting depth mark is reached, excess mortar must be emerged from the mouth of the drill hole.</p> |
| 10 |  <p>Wait for the specified curing time t_{cure} see table B7.3</p> |  <p>Mounting the fixture max T_{inst} see table B6.1</p> |

fischer injection system FIS V Zero

Intended use
Installation instructions part 3

Annex B 10

Appendix 17 / 26

Table C1.1: Characteristic values for steel failure under tension / shear load of fischer anchor rods and standard threaded rods

| Anchor rod / standard threaded rod | | M8 | M10 | M12 | M16 | M20 | M24 | | |
|---|--|----------------|-----|---------------------------|--------|-----|-----|-----|-----|
| Bearing capacity under tension load, steel failure ³⁾ | | | | | | | | | |
| Characteristic resistance $N_{Rk,s}$ | Steel zinc plated | Property class | 4.8 | 15(13) | 23(21) | 33 | 63 | 98 | 141 |
| | | | 5.8 | 19(17) | 29(27) | 43 | 79 | 123 | 177 |
| | | | 8.8 | 29(27) | 47(43) | 68 | 126 | 196 | 282 |
| | Stainless steel R and high corrosion resistant steel HCR | | 50 | 19 | 29 | 43 | 79 | 123 | 177 |
| | | | 70 | 26 | 41 | 59 | 110 | 172 | 247 |
| | | | 80 | 30 | 47 | 68 | 126 | 196 | 282 |
| Partial factors ¹⁾ | | | | | | | | | |
| Partial factor $\gamma_{Ms,N}$ | Steel zinc plated | Property class | 4.8 | 1,50 | | | | | |
| | | | 5.8 | 1,50 | | | | | |
| | | | 8.8 | 1,50 | | | | | |
| | Stainless steel R and high corrosion resistant steel HCR | | 50 | 2,86 | | | | | |
| | | | 70 | 1,50 ²⁾ / 1,87 | | | | | |
| | | | 80 | 1,60 | | | | | |
| Bearing capacity under shear load, steel failure ³⁾ | | | | | | | | | |
| without lever arm | | | | | | | | | |
| Characteristic resistance $V_{Rk,s}^0$ | Steel zinc plated | Property class | 4.8 | 9(8) | 14(13) | 20 | 38 | 59 | 85 |
| | | | 5.8 | 11(10) | 17(16) | 25 | 47 | 74 | 106 |
| | | | 8.8 | 15(13) | 23(21) | 34 | 63 | 98 | 141 |
| | Stainless steel R and high corrosion resistant steel HCR | | 50 | 9 | 15 | 21 | 39 | 61 | 89 |
| | | | 70 | 13 | 20 | 30 | 55 | 86 | 124 |
| | | | 80 | 15 | 23 | 34 | 63 | 98 | 141 |
| Ductility factor | | k ₇ | [-] | 1,0 | | | | | |
| with lever arm | | | | | | | | | |
| Characteristic resistance $M_{Rk,s}^0$ | Steel zinc plated | Property class | 4.8 | 15(13) | 30(27) | 52 | 133 | 259 | 448 |
| | | | 5.8 | 19(16) | 37(33) | 65 | 166 | 324 | 560 |
| | | | 8.8 | 30(26) | 60(53) | 105 | 266 | 519 | 896 |
| | Stainless steel R and high corrosion resistant steel HCR | | 50 | 19 | 37 | 65 | 166 | 324 | 560 |
| | | | 70 | 26 | 52 | 92 | 232 | 454 | 784 |
| | | | 80 | 30 | 60 | 105 | 266 | 519 | 896 |
| Partial factors ¹⁾ | | | | | | | | | |
| Partial factor $\gamma_{Ms,V}$ | Steel zinc plated | Property class | 4.8 | 1,25 | | | | | |
| | | | 5.8 | 1,25 | | | | | |
| | | | 8.8 | 1,25 | | | | | |
| | Stainless steel R and high corrosion resistant steel HCR | | 50 | 2,38 | | | | | |
| | | | 70 | 1,25 ²⁾ / 1,56 | | | | | |
| | | | 80 | 1,33 | | | | | |

1) In absence of other national regulations

2) Only admissible for high corrosion resist. steel HCR, with $f_{yk} / f_{uk} \geq 0,8$ and $A_5 > 12 \%$ (e.g. fischer anchor rods)

3) Values in brackets are valid for undersized threaded rods with smaller stress area A_s for hot dip galvanised standard threaded rods according to EN ISO 10684:2004+AC:2009

fischer injection system FIS V Zero

Performances

Characteristic values for steel failure under tension / shear load of fischer anchor rods and standard threaded rods

Annex C 1

Table C2.1: Characteristic values for steel failure under tension / shear load of fischer internal threaded anchors RG M I

| fischer internal threaded anchors RG M I | | | M8 | M10 | M12 | M16 | |
|---|-----------------|-------|------|------|------|------|------|
| Bearing capacity under tension load, steel failure | | | | | | | |
| Charact. resistance with screw | Property class | 5.8 | [kN] | 19 | 29 | 43 | 79 |
| | | 8.8 | | 29 | 47 | 68 | 108 |
| | | R | | 26 | 41 | 59 | 110 |
| | | HCR | | 26 | 41 | 59 | 110 |
| Partial factors¹⁾ | | | | | | | |
| Partial factors | $\gamma_{Ms,N}$ | 5.8 | [-] | 1,50 | | | |
| | | 8.8 | | 1,50 | | | |
| | | R | | 1,87 | | | |
| | | HCR | | 1,87 | | | |
| Bearing capacity under shear load, steel failure | | | | | | | |
| Without lever arm | | | | | | | |
| Charact. resistance with screw | Property class | 5.8 | [kN] | 9,2 | 14,5 | 21,1 | 39,2 |
| | | 8.8 | | 14,6 | 23,2 | 33,7 | 54,0 |
| | | R | | 12,8 | 20,3 | 29,5 | 54,8 |
| | | HCR | | 12,8 | 20,3 | 29,5 | 54,8 |
| Ductility factor | | k_7 | [-] | 1,0 | | | |
| With lever arm | | | | | | | |
| Charact. resistance with screw | Property class | 5.8 | [Nm] | 20 | 39 | 68 | 173 |
| | | 8.8 | | 30 | 60 | 105 | 266 |
| | | R | | 26 | 52 | 92 | 232 |
| | | HCR | | 26 | 52 | 92 | 232 |
| Partial factors¹⁾ | | | | | | | |
| Partial factors | $\gamma_{Ms,V}$ | 5.8 | [-] | 1,25 | | | |
| | | 8.8 | | 1,25 | | | |
| | | R | | 1,56 | | | |
| | | HCR | | 1,56 | | | |

¹⁾ In absence of other national regulations

fischer injection system FIS V Zero

Performances

Characteristic values for steel failure under tension / shear load of fischer internal threaded anchor RG M I

Annex C 2

Table C3.1: Characteristic values for steel failure under tension / shear load of reinforcing bars

| Nominal diameter of the bar | ϕ | 8 | 10 | 12 | 14 | 16 | 20 | 22 | 24 | 25 |
|---|--------------|------|--|----|----|----|----|----|----|----|
| Bearing capacity under tension load, steel failure | | | | | | | | | | |
| Characteristic resistance | $N_{Rk,s}$ | [kN] | $A_s \cdot f_{uk}^{(2)}$ | | | | | | | |
| Bearing capacity under shear load, steel failure | | | | | | | | | | |
| Without lever arm | | | | | | | | | | |
| Characteristic resistance | $V^0_{Rk,s}$ | [kN] | $k_6^{(1)} \cdot A_s \cdot f_{uk}^{(2)}$ | | | | | | | |
| Ductility factor | k_7 | [-] | 1,0 | | | | | | | |
| With lever arm | | | | | | | | | | |
| Characteristic resistance | $M^0_{Rk,s}$ | [Nm] | $1,2 \cdot W_{el} \cdot f_{uk}^{(2)}$ | | | | | | | |

- 1) In accordance with EN 1992-4:2018 section 7.2.2.3.1
 $k_6 = 0,6$ for fasteners made of carbon steel with $f_{uk} \leq 500 \text{ N/mm}^2$
 $= 0,5$ for fasteners made of carbon steel with $500 < f_{uk} \leq 1000 \text{ N/mm}^2$
 $= 0,5$ for fasteners made of stainless steel
- 2) f_{uk} or f_{yk} respectively must be taken from the specifications of the reinforcing bar

Table C3.2: Characteristic values for steel failure under tension / shear load of fischer rebar anchors FRA

| fischer rebar anchor FRA | | M12 | M16 | M20 | M24 | |
|---|-----------------|------|------|-----|-----|-----|
| Bearing capacity under tension load, steel failure | | | | | | |
| Characteristic resistance | $N_{Rk,s}$ | [kN] | 59 | 110 | 172 | 270 |
| Partial factor¹⁾ | | | | | | |
| Partial factor | $\gamma_{Ms,N}$ | [-] | 1,4 | | | |
| Bearing capacity under shear load, steel failure | | | | | | |
| Without lever arm | | | | | | |
| Characteristic resistance | $V^0_{Rk,s}$ | [kN] | 30 | 55 | 86 | 141 |
| Ductility factor | k_7 | [-] | 1,0 | | | |
| With lever arm | | | | | | |
| Characteristic resistance | $M^0_{Rk,s}$ | [Nm] | 92 | 233 | 454 | 898 |
| Partial factor¹⁾ | | | | | | |
| Partial factor | $\gamma_{Ms,V}$ | [-] | 1,56 | | | |

¹⁾ In absence of other national regulations

fischer injection system FIS V Zero

Performances

Characteristic values for steel failure under tension / shear load of reinforcing bars and fischer rebar anchors FRA

Annex C 3

Table C4.1: Characteristic values for **concrete failure** under **tension / shear load**

| Size | | All sizes | | | | | | | | | | | |
|---|--------------------------|-----------------|---------------|--|----------------------|---------------|-----|----------------|-----|----|----|----|----|
| Tension load | | | | | | | | | | | | | |
| Installation factor | | γ_{inst} | [-] | | See annex C 5 to C 8 | | | | | | | | |
| Factors for the compressive strength of concrete > C20/25 | | | | | | | | | | | | | |
| Increasing factor for τ_{RK} | C25/30 | | Ψ_c | [-] | 1,03 | | | | | | | | |
| | C30/37 | | | | 1,06 | | | | | | | | |
| | C35/45 | | | | 1,09 | | | | | | | | |
| | C40/50 | | | | 1,11 | | | | | | | | |
| | C45/55 | | | | 1,13 | | | | | | | | |
| | C50/60 | | | | 1,15 | | | | | | | | |
| Splitting failure | | | | | | | | | | | | | |
| Edge distance | $h / h_{ef} \geq 2,0$ | | $C_{cr,sp}$ | [mm] | 1,0 h_{ef} | | | | | | | | |
| | $2,0 > h / h_{ef} > 1,3$ | | | | 4,6 h_{ef} - 1,8 h | | | | | | | | |
| | $h / h_{ef} \leq 1,3$ | | | | 2,26 h_{ef} | | | | | | | | |
| Spacing | | $S_{cr,sp}$ | 2 $C_{cr,sp}$ | | | | | | | | | | |
| Concrete cone failure | | | | | | | | | | | | | |
| Uncracked concrete | | $k_{ucr,N}$ | [-] | 11,0 | | | | | | | | | |
| Cracked concrete | | $k_{cr,N}$ | | 7,7 | | | | | | | | | |
| Edge distance | | $C_{cr,N}$ | [mm] | 1,5 h_{ef} | | | | | | | | | |
| Spacing | | $S_{cr,N}$ | | 2 $C_{cr,N}$ | | | | | | | | | |
| Factors for sustained tension load | | | | | | | | | | | | | |
| Temperature range | | | [-] | 24 °C / 40 °C | | 50 °C / 80 °C | | 72 °C / 120 °C | | | | | |
| Factor | | Ψ_{sus}^0 | [-] | 0,67 | | 0,67 | | 0,75 | | | | | |
| Shear load | | | | | | | | | | | | | |
| Installation factor | | γ_{inst} | [-] | | 1,0 | | | | | | | | |
| Concrete pry-out failure | | | | | | | | | | | | | |
| Factor for pry-out failure | | k_B | [-] | | 2,0 | | | | | | | | |
| Concrete edge failure | | | | | | | | | | | | | |
| Effective length of fastener in shear loading | | l_f | [mm] | for $d_{nom} \leq 24$ mm: min (h_{ef} ; 12 d_{nom}) for $d_{nom} > 24$ mm: min (h_{ef} ; 8 d_{nom} ; 300 mm) | | | | | | | | | |
| Calculation diameters | | | | | | | | | | | | | |
| Size | | | M8 | M10 | M12 | M16 | M20 | M24 | | | | | |
| fischer anchor rods and standard threaded rods | | d_{nom} | [mm] | 8 | 10 | 12 | 16 | 20 | 24 | | | | |
| fischer internal threaded anchors RG M I | | d_{nom} | | 12 | 16 | 18 | 22 | -1) | -1) | | | | |
| fischer rebar anchor FRA | | d_{nom} | | -1) | -1) | 12 | 16 | 20 | 25 | | | | |
| Size (nominal diameter of the bar) | | | ϕ | 8 | 10 | 12 | 14 | 16 | 20 | 22 | 24 | 25 | |
| Reinforcing bar | | | d_{nom} | [mm] | 8 | 10 | 12 | 14 | 16 | 20 | 22 | 24 | 25 |

¹⁾ Anchor type not part of the assessment

fischer injection system FIS V Zero

Performances

Characteristic values for concrete failure under tension / shear load

Annex C 4

Table C5.1: Characteristic values for **combined pull-out** and **concrete failure** for **fischer anchor rods** and **standard threaded rods** in hammer drilled holes; **uncracked or cracked concrete**

| Anchor rod / standard threaded rod | | M8 | M10 | M12 | M16 | M20 | M24 | |
|---|---------------------|--------------------------------------|-----------------|-----|-----|-----|--------------------------------------|-----|
| Combined pullout and concrete cone failure | | | | | | | | |
| Calculation diameter | d [mm] | 8 | 10 | 12 | 16 | 20 | 24 | |
| Uncracked concrete | | | | | | | | |
| Characteristic bond resistance in uncracked concrete C20/25 | | | | | | | | |
| Hammer-drilling with standard drill bit (dry or wet concrete, water filled hole) | | | | | | | | |
| Tem- perature range | I: 24 °C / 40 °C | $\tau_{Rk,ucr}$ [N/mm ²] | 10 | 10 | 10 | 10 | 9,5 | 8,5 |
| | II: 50 °C / 80 °C | | 10 | 10 | 10 | 10 | 9,5 | 8,5 |
| | III: 72 °C / 120 °C | | 8 | 8 | 8 | 8 | 8 | 7 |
| Hammer-drilling with hollow drill bit (dry or wet concrete) | | | | | | | | |
| Tem- perature range | I: 24 °C / 40 °C | $\tau_{Rk,ucr}$ [N/mm ²] | - ¹⁾ | 6,5 | 6 | 6 | 6 | 5 |
| | II: 50 °C / 80 °C | | - ¹⁾ | 6,5 | 6 | 6 | 6 | 5 |
| | III: 72 °C / 120 °C | | - ¹⁾ | 5,5 | 5 | 5 | 5 | 4,5 |
| Installation factors | | | | | | | | |
| Dry or wet concrete and water filled hole | γ_{inst} | [-] | 1,4 | | | | | |
| Cracked concrete | | | | | | | | |
| Characteristic bond resistance in cracked concrete C20/25 | | | | | | | | |
| Hammer-drilling with standard drill bit (dry or wet concrete, water filled hole) | | | | | | | | |
| Tem- perature range | I: 24 °C / 40 °C | $\tau_{Rk,cr}$ [N/mm ²] | 4 | 4 | 4 | 4 | 4 | 4 |
| | II: 50 °C / 80 °C | | 4 | 4 | 4 | 4 | 4 | 4 |
| | III: 72 °C / 120 °C | | 3 | 3 | 3,5 | 3,5 | 3,5 | 3,5 |
| Installation factors | | | | | | | | |
| Dry or wet concrete and water filled hole | γ_{inst} | [-] | 1,4 | | | | | |
| ¹⁾ No performance assessed | | | | | | | | |
| fischer injection system FIS V Zero | | | | | | | Annex C 5 Appendix 22 / 26 | |
| Performances Characteristic values for combined pull-out and concrete failure for fischer anchor rod and standard threaded rods | | | | | | | | |

Table C6.1: Characteristic values for **combined pull-out** and **concrete failure** for **fischer internal threaded anchors RG M I** in hammer drilled holes; **uncracked or cracked concrete**

| Internal threaded anchor RG M I | | M8 | M10 | M12 | M16 | |
|--|---------------------|--------------------------------------|-----|-----|--------------------------------------|-----|
| Combined pullout and concrete cone failure | | | | | | |
| Calculation diameter | d [mm] | 12 | 16 | 18 | 22 | |
| Uncracked concrete | | | | | | |
| Characteristic bond resistance in uncracked concrete C20/25 | | | | | | |
| Hammer-drilling with standard drill bit (dry or wet concrete, water filled hole) | | | | | | |
| Tem- perature range | I: 24 °C / 40 °C | $\tau_{Rk,ucr}$ [N/mm ²] | 7,5 | 7,5 | 7,5 | 7 |
| | II: 50 °C / 80 °C | | 7,5 | 7,5 | 7,5 | 7 |
| | III: 72 °C / 120 °C | | 6,5 | 6,5 | 6,5 | 6 |
| Hammer-drilling with hollow drill bit (dry or wet concrete) | | | | | | |
| Tem- perature range | I: 24 °C / 40 °C | $\tau_{Rk,ucr}$ [N/mm ²] | 6,5 | 6,5 | 6,5 | 6,5 |
| | II: 50 °C / 80 °C | | 6,5 | 6,5 | 6,5 | 6,5 |
| | III: 72 °C / 120 °C | | 5,5 | 5,5 | 5,5 | 5,5 |
| Installation factors | | | | | | |
| Dry or wet concrete and water filled hole | γ_{inst} | [-] | 1,4 | | | |
| Cracked concrete | | | | | | |
| Characteristic bond resistance in cracked concrete C20/25 | | | | | | |
| Hammer-drilling with standard drill bit (dry or wet concrete, water filled hole) | | | | | | |
| Tem- perature range | I: 24 °C / 40 °C | $\tau_{Rk,cr}$ [N/mm ²] | 4,5 | 4 | 4 | 3,5 |
| | II: 50 °C / 80 °C | | 4,5 | 4 | 4 | 3,5 |
| | III: 72 °C / 120 °C | | 3,5 | 3,5 | 3 | 3 |
| Installation factors | | | | | | |
| Dry or wet concrete and water filled hole | γ_{inst} | [-] | 1,4 | | | |
| | | | | | | |
| fischer injection system FIS V Zero | | | | | Annex C 6 Appendix 23 / 26 | |
| Performances Characteristic values for combined pull-out and concrete failure for fischer internal threaded anchors RG M I | | | | | | |

Table C7.1: Characteristic values for **combined pull-out and concrete failure** for **reinforcing bars** in hammer drilled holes; **uncracked concrete**

| Nominal diameter of the bar | | ϕ | 8 | 10 | 12 | 14 | 16 | 20 | 22 | 24 | 25 | | |
|---|---------------------|-----------------|-----------------|----------------------|-----|-----|----|-----|-----|-----|-----|-----|-----|
| Combined pullout and concrete cone failure | | | | | | | | | | | | | |
| Calculation diameter | | d | [mm] | 8 | 10 | 12 | 14 | 16 | 20 | 22 | 24 | 25 | |
| Uncracked concrete | | | | | | | | | | | | | |
| Characteristic bond resistance in uncracked concrete C20/25 | | | | | | | | | | | | | |
| <u>Hammer-drilling with standard drill bit (dry or wet concrete, water filled hole)</u> | | | | | | | | | | | | | |
| Tem- perature range | I: 24 °C / 40 °C | | $\tau_{Rk,ucr}$ | [N/mm ²] | 6,5 | 7 | 7 | 7,5 | 7,5 | 8 | 8 | 8 | 8 |
| | II: 50 °C / 80 °C | | | | 6,5 | 7 | 7 | 7,5 | 7,5 | 8 | 8 | 8 | 8 |
| | III: 72 °C / 120 °C | | | | 5,5 | 5,5 | 6 | 6 | 6,5 | 6,5 | 6,5 | 6,5 | 6,5 |
| <u>Hammer-drilling with hollow drill bit (dry or wet concrete)</u> | | | | | | | | | | | | | |
| Tem- perature range | I: 24 °C / 40 °C | | $\tau_{Rk,ucr}$ | [N/mm ²] | 6 | 6 | 6 | 6 | 6 | 6 | 5,5 | 5,5 | 5,5 |
| | II: 50 °C / 80 °C | | | | 6 | 6 | 6 | 6 | 6 | 6 | 5,5 | 5,5 | 5,5 |
| | III: 72 °C / 120 °C | | | | 5 | 5 | 5 | 5 | 5 | 5 | 4,5 | 4,5 | 4,5 |
| Installation factors | | | | | | | | | | | | | |
| Dry or wet concrete and water filled hole | | γ_{inst} | [-] | 1,4 | | | | | | | | | |

Table C7.2: Characteristic values for **combined pull-out and concrete failure** for **fischer rebar anchors FRA** in hammer drilled holes; **uncracked concrete**

| fischer rebar anchors FRA | | M12 | M16 | M20 | M24 | | | |
|---|---------------------|-----------------|-----------------|----------------------|-----|-----|-----|-----|
| Combined pullout and concrete cone failure | | | | | | | | |
| Calculation diameter | | d | [mm] | 12 | 16 | 20 | 25 | |
| Uncracked concrete | | | | | | | | |
| Characteristic bond resistance in uncracked concrete C20/25 | | | | | | | | |
| <u>Hammer-drilling with standard drill bit (dry or wet concrete, water filled hole)</u> | | | | | | | | |
| Tem- perature range | I: 24 °C / 40 °C | | $\tau_{Rk,ucr}$ | [N/mm ²] | 7 | 7,5 | 8 | 8 |
| | II: 50 °C / 80 °C | | | | 7 | 7,5 | 8 | 8 |
| | III: 72 °C / 120 °C | | | | 6 | 6,5 | 6,5 | 6,5 |
| <u>Hammer-drilling with hollow drill bit (dry or wet concrete)</u> | | | | | | | | |
| Tem- perature range | I: 24 °C / 40 °C | | $\tau_{Rk,ucr}$ | [N/mm ²] | 6 | 6 | 6 | 5,5 |
| | II: 50 °C / 80 °C | | | | 6 | 6 | 6 | 5,5 |
| | III: 72 °C / 120 °C | | | | 5 | 5 | 5 | 4,5 |
| Installation factors | | | | | | | | |
| Dry or wet concrete and water filled hole | | γ_{inst} | [-] | 1,4 | | | | |

| | | |
|---|--|--------------------------------------|
| fischer injection system FIS V Zero | | Annex C 7 Appendix 24 / 26 |
| Performances Characteristic values for combined pull-out and concrete failure for reinforcing bars and fischer rebar anchor FRA | | |

Table C8.1: Displacements for anchor rods

| Anchor rod | M8 | M10 | M12 | M16 | M20 | M24 | |
|---|---------------------------|------|--|------|------|------|------|
| Displacement-Factors for tension load¹⁾ | | | | | | | |
| Uncracked concrete; Temperature range I, II, III | | | | | | | |
| δ_{N0} -Factor | [mm/(N/mm ²)] | 0,04 | 0,04 | 0,05 | 0,06 | 0,07 | 0,08 |
| $\delta_{N\infty}$ -Factor | | 0,04 | 0,04 | 0,05 | 0,06 | 0,07 | 0,08 |
| Cracked concrete; Temperature range I, II, III | | | | | | | |
| δ_{N0} -Factor | [mm/(N/mm ²)] | 0,10 | 0,11 | 0,11 | 0,13 | 0,14 | 0,16 |
| $\delta_{N\infty}$ -Factor | | 0,10 | 0,11 | 0,11 | 0,13 | 0,14 | 0,16 |
| Displacement-Factors for shear load²⁾ | | | | | | | |
| Uncracked or cracked concrete; Temperature range I, II, III | | | | | | | |
| δ_{V0} -Factor | [mm/kN] | 0,18 | 0,15 | 0,12 | 0,09 | 0,07 | 0,06 |
| $\delta_{V\infty}$ -Factor | | 0,27 | 0,22 | 0,18 | 0,14 | 0,11 | 0,09 |
| 1) Calculation of effective displacement: $\delta_{N0} = \delta_{N0}\text{-Factor} \cdot \tau_{Ed}$ $\delta_{N\infty} = \delta_{N\infty}\text{-Factor} \cdot \tau_{Ed}$ (τ_{Ed} : Design value of the applied tensile bond stress) | | | 2) Calculation of effective displacement: $\delta_{V0} = \delta_{V0}\text{-Factor} \cdot V_{Ed}$ $\delta_{V\infty} = \delta_{V\infty}\text{-Factor} \cdot V_{Ed}$ (V_{Ed} : Design value of the applied shear force) | | | | |

Table C8.2: Displacements for fischer internal threaded anchors RG M I

| Internal threaded anchor RG M I | M8 | M10 | M12 | M16 | |
|---|---------------------------|--|------|------|------|
| Displacement-Factors for tension load¹⁾ | | | | | |
| Uncracked concrete; Temperature range I, II, III | | | | | |
| δ_{N0} -Factor | [mm/(N/mm ²)] | 0,06 | 0,07 | 0,07 | 0,07 |
| $\delta_{N\infty}$ -Factor | | 0,06 | 0,07 | 0,07 | 0,07 |
| Cracked concrete; Temperature range I, II, III | | | | | |
| δ_{N0} -Factor | [mm/(N/mm ²)] | 0,10 | 0,11 | 0,11 | 0,12 |
| $\delta_{N\infty}$ -Factor | | 0,10 | 0,11 | 0,11 | 0,12 |
| Displacement-Factors for shear load²⁾ | | | | | |
| Uncracked or cracked concrete; Temperature range I, II, III | | | | | |
| δ_{V0} -Factor | [mm/kN] | 0,12 | 0,09 | 0,08 | 0,07 |
| $\delta_{V\infty}$ -Factor | | 0,18 | 0,14 | 0,12 | 0,10 |
| 1) Calculation of effective displacement: $\delta_{N0} = \delta_{N0}\text{-Factor} \cdot \tau_{Ed}$ $\delta_{N\infty} = \delta_{N\infty}\text{-Factor} \cdot \tau_{Ed}$ (τ_{Ed} : Design value of the applied tensile bond stress) | | 2) Calculation of effective displacement: $\delta_{V0} = \delta_{V0}\text{-Factor} \cdot V_{Ed}$ $\delta_{V\infty} = \delta_{V\infty}\text{-Factor} \cdot V_{Ed}$ (V_{Ed} : Design value of the applied shear force) | | | |

fischer injection system FIS V Zero

Performances

Displacements for anchor rods and fischer internal threaded anchor rods

Annex C 8

Appendix 25 / 26

Table C9.1: Displacements for reinforcing bars

| Nominal diameter of the bar ϕ | | 8 | 10 | 12 | 14 | 16 | 20 | 22 | 24 | 25 |
|---|---------------------------|------|------|------|--|------|------|------|------|------|
| Displacement-Factors for tension load¹⁾ | | | | | | | | | | |
| Uncracked concrete; Temperature range I, II, III | | | | | | | | | | |
| δ_{N0} -Factor | [mm/(N/mm ²)] | 0,05 | 0,06 | 0,07 | 0,08 | 0,09 | 0,10 | 0,11 | 0,12 | 0,12 |
| $\delta_{N\infty}$ -Factor | | 0,05 | 0,06 | 0,07 | 0,08 | 0,09 | 0,10 | 0,11 | 0,12 | 0,12 |
| Displacement-Factors for shear load²⁾ | | | | | | | | | | |
| Uncracked concrete; Temperature range I, II, III | | | | | | | | | | |
| δ_{V0} -Factor | [mm/kN] | 0,18 | 0,15 | 0,12 | 0,10 | 0,09 | 0,07 | 0,07 | 0,06 | 0,06 |
| $\delta_{V\infty}$ -Factor | | 0,27 | 0,22 | 0,18 | 0,16 | 0,14 | 0,11 | 0,10 | 0,09 | 0,09 |
| 1) Calculation of effective displacement: $\delta_{N0} = \delta_{N0}\text{-Factor} \cdot \tau_{Ed}$ $\delta_{N\infty} = \delta_{N\infty}\text{-Factor} \cdot \tau_{Ed}$ (τ_{Ed} : Design value of the applied tensile bond stress) | | | | | 2) Calculation of effective displacement: $\delta_{V0} = \delta_{V0}\text{-Factor} \cdot V_{Ed}$ $\delta_{V\infty} = \delta_{V\infty}\text{-Factor} \cdot V_{Ed}$ (V_{Ed} : Design value of the applied shear force) | | | | | |

Table C9.2: Displacements for fischer rebar anchors FRA

| fischer rebar anchor FRA | | M12 | M16 | M20 | M24 |
|---|---------------------------|------|--|------|------|
| Displacement-Factors for tension load¹⁾ | | | | | |
| Uncracked concrete; Temperature range I, II, III | | | | | |
| δ_{N0} -Factor | [mm/(N/mm ²)] | 0,07 | 0,09 | 0,10 | 0,12 |
| $\delta_{N\infty}$ -Factor | | 0,07 | 0,09 | 0,10 | 0,12 |
| Displacement-Factors for shear load²⁾ | | | | | |
| Uncracked concrete; Temperature range I, II, III | | | | | |
| δ_{V0} -Factor | [mm/kN] | 0,12 | 0,09 | 0,07 | 0,06 |
| $\delta_{V\infty}$ -Factor | | 0,18 | 0,14 | 0,11 | 0,09 |
| 1) Calculation of effective displacement: $\delta_{N0} = \delta_{N0}\text{-Factor} \cdot \tau_{Ed}$ $\delta_{N\infty} = \delta_{N\infty}\text{-Factor} \cdot \tau_{Ed}$ (τ_{Ed} : Design value of the applied tensile bond stress) | | | 2) Calculation of effective displacement: $\delta_{V0} = \delta_{V0}\text{-Factor} \cdot V_{Ed}$ $\delta_{V\infty} = \delta_{V\infty}\text{-Factor} \cdot V_{Ed}$ (V_{Ed} : Design value of the applied shear force) | | |