

PRESTATIEVERKLARING

DoP 0346

voor fischer TermoZ CS II 8; fischer TermoZ CS II 8 DT 110 V (Kunststof verbindingen voor gebruik in beton en metselwerk)

NL

1. Unieke identificatiecode van het producttype: DoP 0346
2. Beoogd(e) gebruik(en): Ingeschroefd kunststof anker voor bevestiging van externe thermische isolatie-composiet systemen (ETICS) met bepleistering in beton, metselwerk, licht korrelbeton en gasbeton en voor bevestiging aan de onderkant van betonnen plafonds, Zie bijlage, met name de bijlagen B1- B4.
3. Fabrikant: fischerwerke GmbH & Co. KG, Klaus-Fischer-Str. 1, 72178 Waldachtal, Duitsland
4. Gemachtigde: -
5. Het systeem of de systemen voor de beoordeling en verificatie van de prestatiebestendigheid: 2+
6. Europees beoordelingsdocument: EAD 330196-01-0604-v01
Europese technische beoordeling: ETA-14/0372; 2023-11-03
Technische beoordelingsinstantie: ETA-Danmark A/S
Aangemelde instantie(s): 2873 TU Darmstadt
7. Aangegeven prestatie(s):
Veilig gebruik (BWR 4)
Karakteristiek draagvermogen van ankers per paneel:
Karakteristieke weerstand onder kortstondige trekbelasting: Bijlage C5
Karakteristieke weerstand onder langdurige trekbelasting: Bijlage C5
Minimale randafstand: Bijlage B3
Minimale hart op hart afstand: Bijlage B3

Verplaatsingen:
Trekbelasting: Bijlage C5
Verplaatsingen op korte termijn: Bijlage C5
Verplaatsingen op lange termijn: Bijlage C5

Plaatstijfheid:
Diameter van de plaat van de plug: Bijlage C3
Belastingsweerstand van de plug: Bijlage C3
Plaatstijfheid: Bijlage C3

Karakteristieke doortrekkcapaciteit voor een paneel:
Minimale dikte van de isolatie: NPD
Karakteristieke doortrekweerstand op korte termijn: NPD
Weerstand op lange termijn: NPD

Energiebesparing en warmtebehoud (BWR 6)
Warmtedoorgangscoefficiënt:
Puntwarmtedoorgangscoefficiënt van de plug: Bijlage C3
Isolerende laagdikte van de ETICS: Bijlage C3
8. Geëigende technische documentatie en/of specifieke technische documentatie: -

De prestaties van het hierboven omschreven product zijn conform de aangegeven prestaties. Deze prestatieverklaring wordt in overeenstemming met Verordening (EU) nr. 305/2011 onder de exclusieve verantwoordelijkheid van de hierboven vermelde fabrikant verstrekt.

Ondertekend voor en namens de fabrikant door:



Dr.-Ing. Oliver Geibig, Managing Director Business Units & Engineering
Tumlingen, 2023-11-17



Jürgen Grün, Managing Director Chemistry & Quality

Deze DoP is opgesteld in meerdere talen. In het geval van geschillen over de interpretatie zal de Engelse tekst altijd prevaleren.

Het aanhangsel bevat vrijwillige en aanvullende informatie in het Engels die de (taal-neutraal gespecificeerde) wettelijke vereisten overschrijdt.

Translation guidance Essential Characteristics and Performance Parameters for Annexes

Vertaal assistent van de essentiële kenmerken en eigenschappen voor bijlagen

Safety in use (BWR 4)

Veilig gebruik (BWR 4)

2: Characteristic load bearing capacity of anchors per panel:

Karakteristiek draagvermogen van ankers per paneel:

| | | |
|--|--|--|
| 2.1 | Characteristic resistance under short-term tension load: Karakteristieke weerstand onder kortstondige trekbelasting: | $N_{Rk,panel,sh}$ [kN/m ²] |
| 2.2 | Characteristic resistance under long-term tension load: Karakteristieke weerstand onder langdurige trekbelasting: | $N_{Rk,panel,lg}$ [kN/m ²] |
| 2.3 | Minimum edge distance: Minimale randafstand: | c_{min} [mm] |
| 2.4 | Minimum spacing: Minimale hart op hart afstand: | s_{min} [mm] |
| 3: Displacements: | | |
| Verplaatsingen: | | |
| 3.1 | Tension load: Trekbelasting: | N [kN] |
| 3.2 | Short-term displacements: Verplaatsingen op korte termijn: | δ_{sh} [mm] |
| 3.3 | Long-term displacements: Verplaatsingen op lange termijn: | δ_{lg} [mm] |
| 4: Plate stiffness: | | |
| Plaatstijfheid: | | |
| 4.1 | Diameter of the anchor insulation fixing element: Diameter van de plaat van de plug: | [mm] |
| 4.2 | Load resistance of the anchor insulation fixing element: Belastingsweerstand van de plug: | [kN] |
| 4.3 | Plate stiffness: Plaatstijfheid: | [kN/mm] |
| 5: Characteristic pull-through capacity for a panel: | | |
| Karakteristieke doortrekcapaciteit voor een paneel: | | |
| 5.1 | Minimum thickness of insulation: Minimale dikte van de isolatie: | [mm] |
| 5.2 | Short-term characteristic pull-through resistance: Karakteristieke doortrekweerstand op korte termijn: | $R_{panel,sh}$ [kN/m ²] |
| 5.3 | Long-term pull-through resistance: Weerstand op lange termijn: | $R_{panel,lg}$ [kN/m ²] |
| Energy economy and heat retention (BWR 6) | | |
| Energiebesparing en warmtebehoud (BWR 6) | | |
| 6: Thermal transmittance: | | |
| Warmtedoorgangscoefficiënt: | | |
| 6.1 | Point thermal transmittance of an anchor: Puntwarmtedoorgangscoefficiënt van de plug: | χ [W/K] |
| 6.2 | Insulating layer thickness of the ETICS: Isolerende laagdikte van de ETICS: | h_D [mm] |

II SPECIFIC PART OF THE EUROPEAN TECHNICAL ASSESSMENT

1 Technical description of product

The screwed-in anchors fischer TermoZ CS II 8 and fischer TermoZ CS II 8 DT 110 V are used for fixing of external thermal insulation composite systems (ETICS). The fischer TermoZ CS II 8 consists of an anchor sleeve made of polypropylene with a diameter of 8 mm and an insulation plate made of glass-fiber reinforced polyamide with a diameter of 60 mm. The fischer TermoZ CS II 8 DT 110 V consists of an anchor sleeve made of polypropylene with a diameter of 8 mm and an insulation plate made of glass-fiber reinforced polyamide with a diameter of 110 mm. The color of the anchor sleeve is grey. The special compound screw is made of galvanised steel and glass-fiber reinforced polyamide. The anchor is expanded by screwing the screw into the sleeve. It is possible to install the anchor flush or countersunk mounted to the surface of the insulation.

The product description is given in Annex A.

2 Specification of the intended use in accordance with the applicable European Assessment Document (hereinafter EAD)

The performances given in Section 3 are only valid if the anchor is used in compliance with the specifications and conditions given in Annex B1 to B3.

The provisions made in this European Technical Assessment are based on an assumed intended working life of the anchor of 25 years.

The indications given on the working life cannot be interpreted as a guarantee given by the producer or Assessment Body, but are to be regarded only as a means for choosing the right products in relation to the expected economically reasonable working life of the works.

3 Performance of the product and references to the methods used for its assessment

3.1 Characteristics of product

Safety in case of fire (BWR 2):

No Performance Assessed.

Safety in use (BWR4):

The essential characteristics are detailed in Annex B3 and Annex C1 to C5.

Characteristic pull-through capacity for a panel:
No performance assessed.

Note. The characteristic pull-through capacity for a panel depends on the relevant panel and is to be assessed for the full ETICS kit taking into account the relevant insulation product.

Energy economy and heat retention (BWR6):

The essential characteristics are detailed in the Annex C3.

Other Basic Requirements are not relevant.

General aspects

The verification of durability is part of testing of the essential characteristics. Durability is only ensured if the specifications of intended use according to Annex B are taken into account.

3.2 Methods of assessment

The assessment of fitness of the anchor for the intended use in relation to the requirements for mechanical resistance and stability and safety in use in the sense of the Basic Requirements 4 has been made in accordance with the EAD 330196-01-0604 Plastic anchors made of virgin or non-virgin material for fixing of external thermal insulation composite systems with rendering as well as EAD 330196-01-0604-v01 - Screwed-in plastic anchors for fixing of external thermal insulation composite systems (ETICS) on bottom side of ceilings.

4 Assessment and verification of constancy of performance (AVCP)

4.1 AVCP system

According to the decision 97/463/EC of the European Commission, the system(s) of assessment and verification of constancy of performance (see Annex V to Regulation (EU) No 305/2011) is 2+.

TermoZ CS II 8

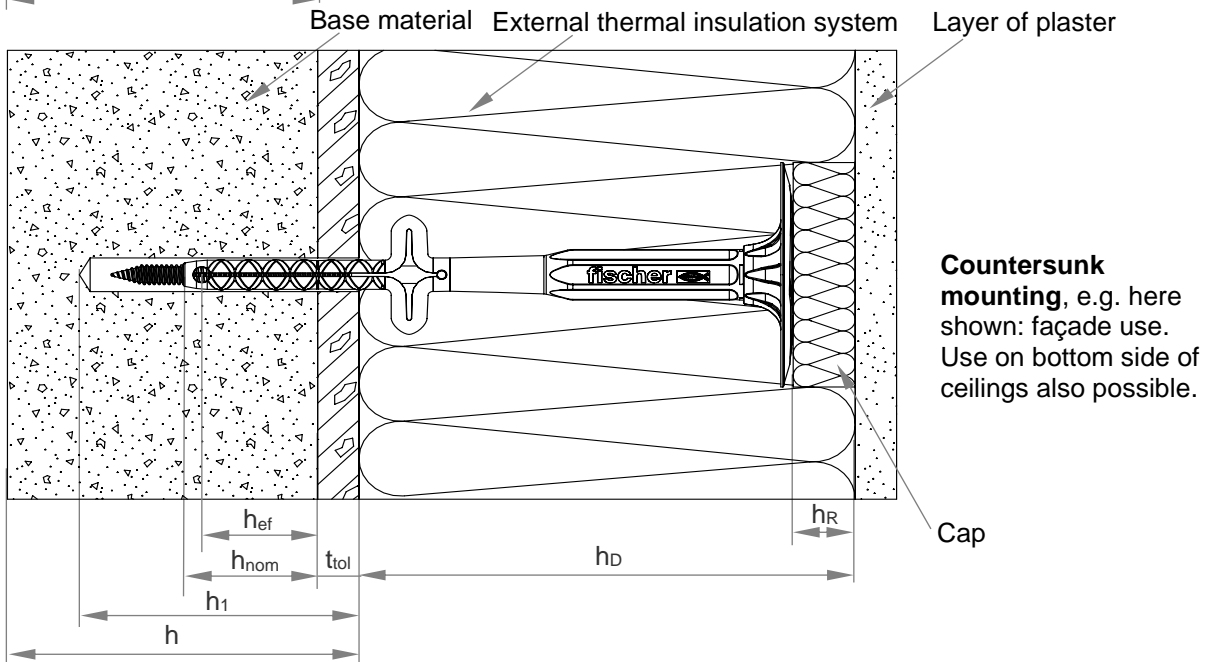
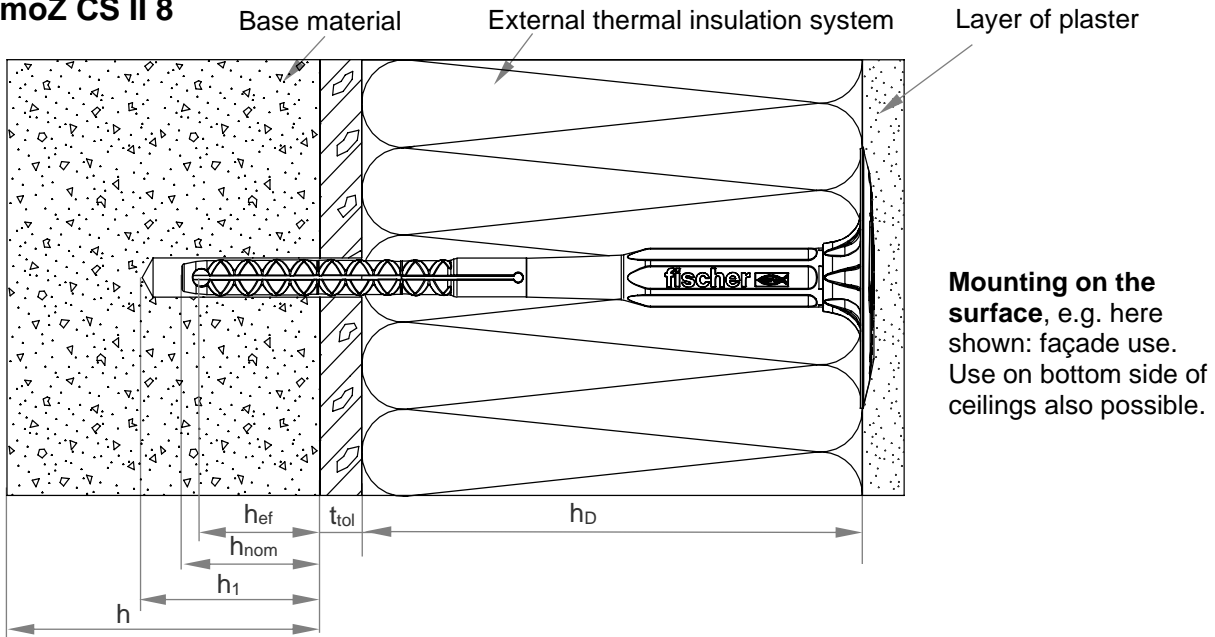

Legend

- h_{nom} = Overall plastic anchor embedment depth in the base material
- h_{ef} = Effective anchorage depth in the base material
- h_1 = Depth of drilled hole to deepest point
- h = Thickness of member (wall)
- h_D = Thickness of insulation material
- t_{tol} = Thickness of equalising layer and / or non-load-bearing coating
- h_R = Thickness of cap

Figures not to scale

fischer TermoZ CS II 8 and fischer TermoZ CS II 8 DT 110 V

Product description

Installed anchor TermoZ CS II 8 for façade use and for use on bottom side of ceilings

Annex A1

TermoZ CS II 8 DT 110 V

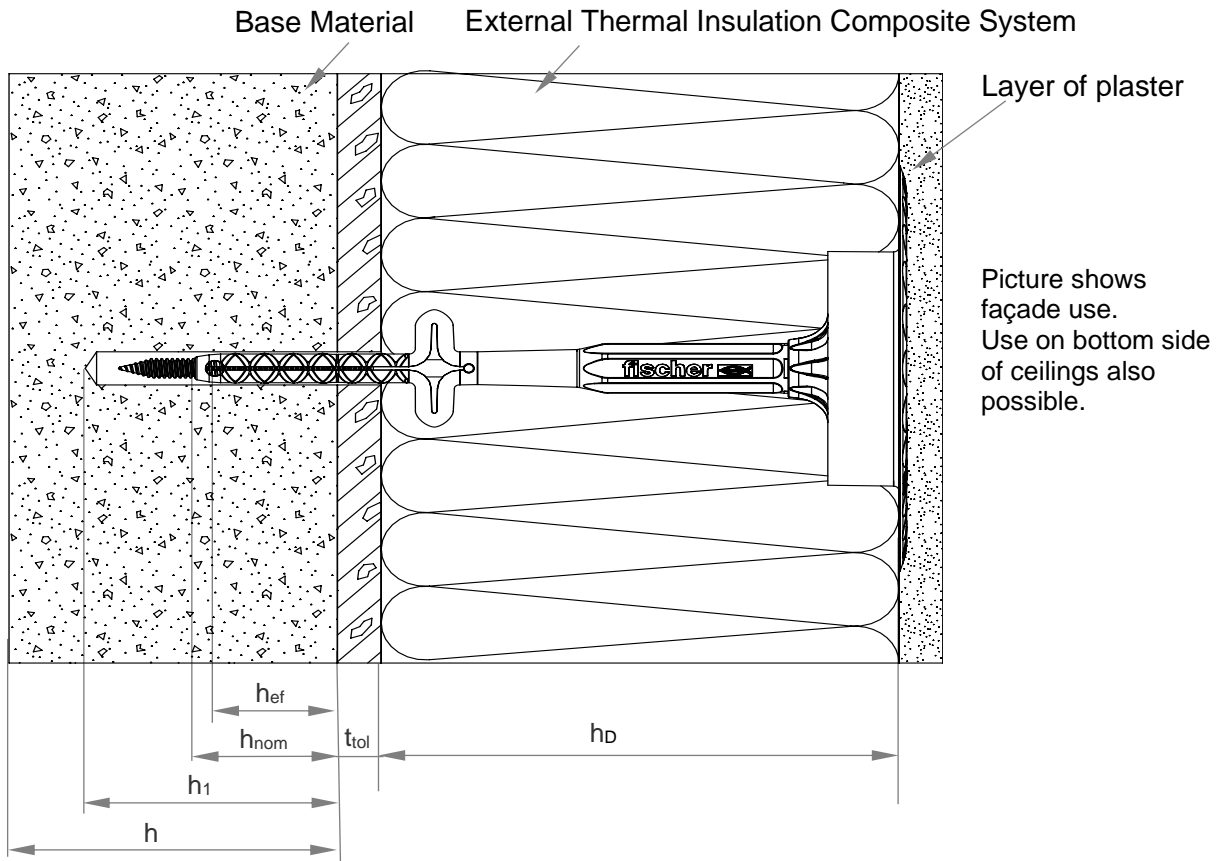

Legend

- h_{nom} = Overall plastic anchor embedment depth in the base material
- h_{ef} = Effective anchorage depth in the base material
- h_1 = Depth of drilled hole to deepest point
- h = Thickness of member (wall)
- h_D = Thickness of insulation material
- t_{tol} = Thickness of equalising layer and / or non-load-bearing coating

Figure not to scale

fischer TermoZ CS II 8 and fischer TermoZ CS II 8 DT 110 V

Product description

Installed anchor TermoZ CS II 8 DT 110 V 8 for façade use and for use on bottom side of ceilings

Annex A2

Anchor sleeve / Specific screw for TermoZ CS II 8/95-255

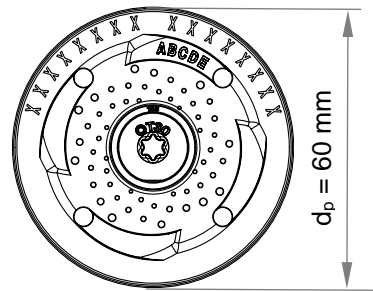
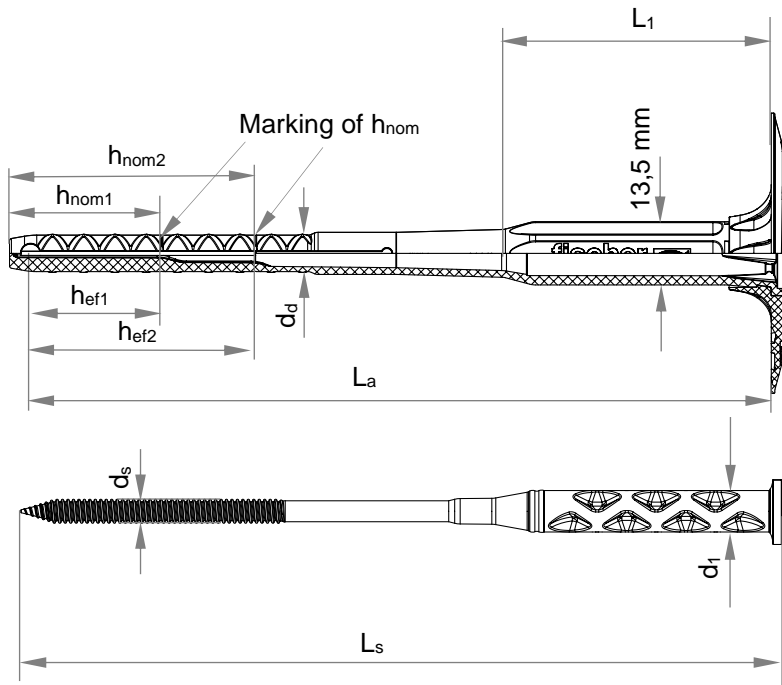

TermoZ CS II 8/95-255
 $95 \text{ mm} \leq L_a \leq 255 \text{ mm}$
 Thickness of insulation material:
 $h_D = (L_a - h_{ef} - t_{tol})$

Anchor sleeve / Specific screw for TermoZ CS II 8/275-455

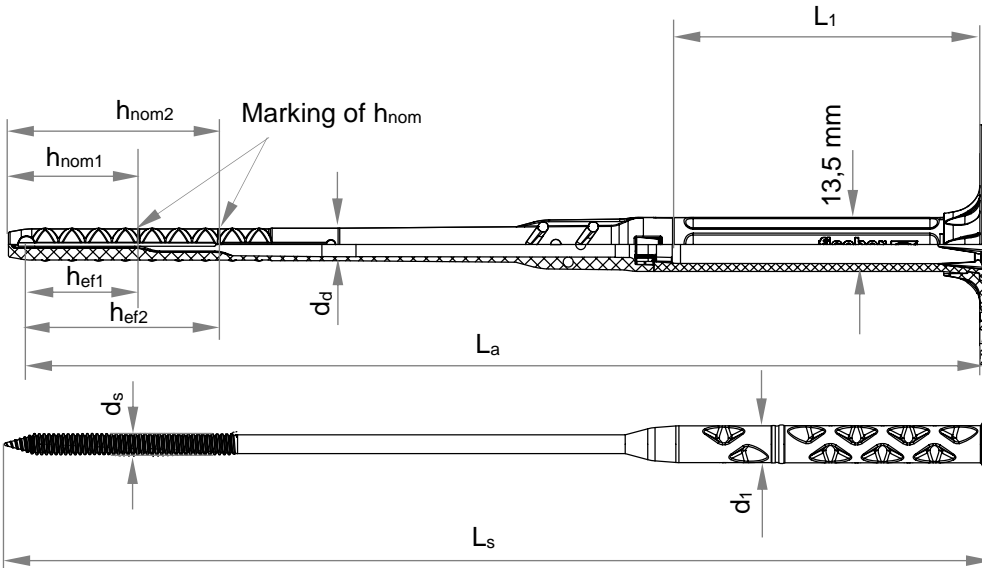

TermoZ CS II 8/275-455
 $275 \text{ mm} \leq L_a \leq 455 \text{ mm}$
 Thickness of insulation material:
 $h_D = (L_a - h_{ef} - t_{tol})$

Figures not to scale

fischer TermoZ CS II 8 and fischer TermoZ CS II 8 DT 110 V

Product description
 Dimensions TermoZ CS II 8

Annex A3

TermoZ CS II 8/115-255 DT 110 V

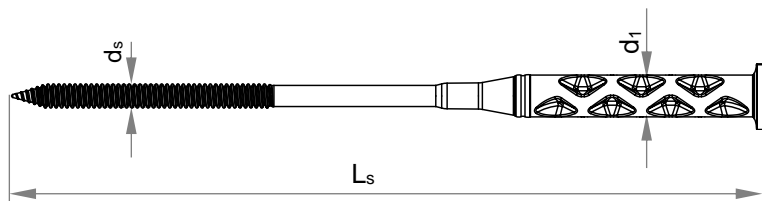
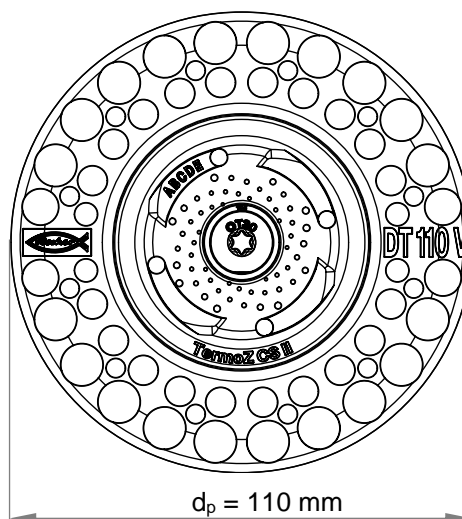
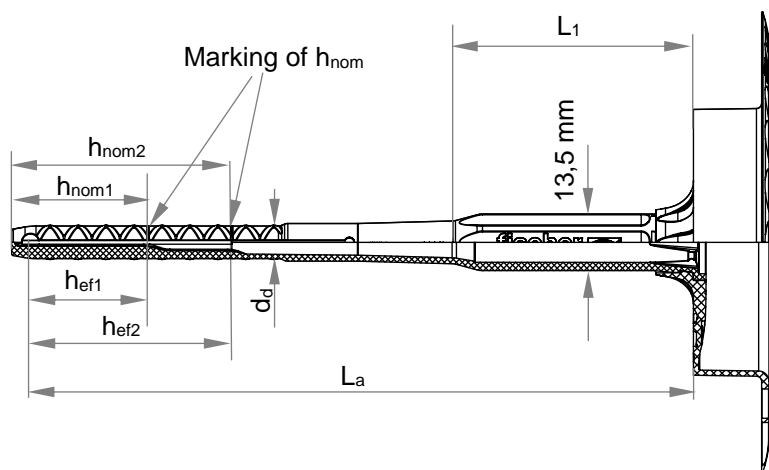

TermoZ CS II 8/115-255 DT 110 V:
 $115 \text{ mm} \leq L_a \leq 255 \text{ mm}$
 Thickness of insulation material:
 $h_D = (L_a - h_{ef} - t_{tol})$

TermoZ CS II 8/275-455 DT 110 V

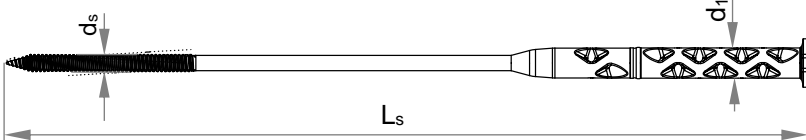
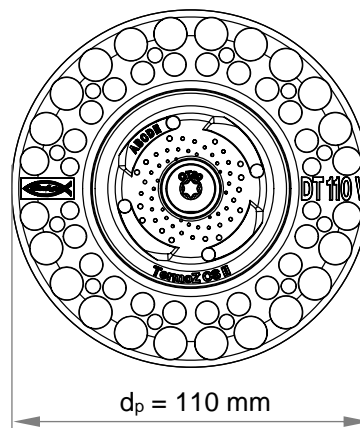
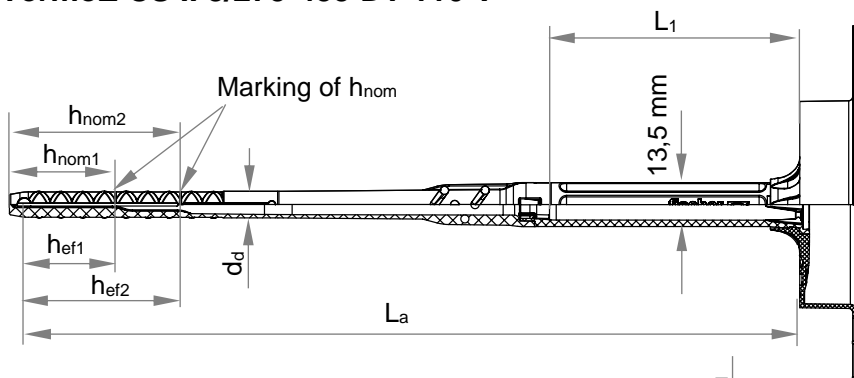

TermoZ CS II 8/275-455 DT 110 V:
 $275 \text{ mm} \leq L_a \leq 455 \text{ mm}$
 Thickness of insulation material:
 $h_D = (L_a - h_{ef} - t_{tol})$

Figures not to scale

fischer TermoZ CS II 8 and fischer TermoZ CS II 8 DT 110 V

Product description
 Dimensions TermoZ CS II 8 DT 110 V

Annex A4

Setting tool with SDS adapter or hexagonal adapter available

Countersunk setting of anchor TermoZ CS II 8
and setting of TermoZ CS II 8 DT 110 V
Note: not possible for TermoZ CS II 8/95

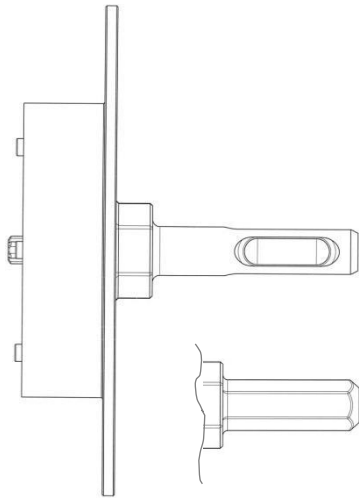

Optional: plain surface setting
Note: not possible for
TermoZ CS II 8 DT 110 V

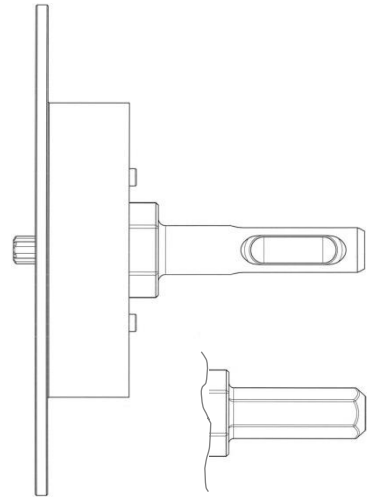

Cap

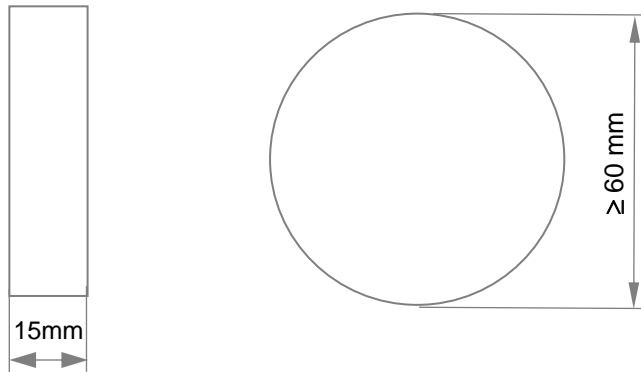

Figures not to scale

fischer TermoZ CS II 8 and fischer TermoZ CS II 8 DT 110 V

Product description
Setting tool and dimensions of cap

Annex A5



| Table A6.1: Marking of plates | |
|--------------------------------------|--|
| | Designation |
| Name of anchor | TermoZ CS II 8 |
| Example | TermoZ CS II ABCDE,  (optional), CE  (optional), Ø 8 (optional) xxxxx additional marks possible |
| Name of anchor | TermoZ CS II 8 DT 110 V |
| Example | TermoZ CS II ABCDE  DT 110 V |

Table A6.2: Dimensions of TermoZ CS II 8

| Anchor type | Anchor sleeve | | | Shaft | | Specific screw | | |
|------------------------|----------------|------------------|-----------------|----------------|----------------|----------------|---------------------|----------------|
| | d _d | h _{nom} | h _{ef} | L _a | L ₁ | d _s | l _s | d ₁ |
| TermoZ CS II 8/95-115 | 8 | 32,5 | 25 | 95-115 | 42 | 5,4 | L _a + 10 | 9,5 |
| TermoZ CS II 8/135-255 | | 32,5 | 25 | 135-255 | 52 | | | |
| | | 52,5 | 45 | | | | | |
| TermoZ CS II 8/275-295 | | 32,5 | 25 | 275-295 | 76 | | | |
| | | 52,5 | 45 | | | | | |
| TermoZ CS II 8/315-375 | | 32,5 | 25 | 315-375 | 156 | | | |
| | | 52,5 | 45 | | | | | |
| TermoZ CS II 8/395-455 | | 32,5 | 25 | 395-455 | 236 | | | |
| | | 52,5 | 45 | | | | | |

Table A6.3: Dimensions of TermoZ CS II 8 DT 110 V

| Anchor type | Anchor sleeve | | | Shaft | | Specific screw | | |
|---------------------------------|----------------|------------------|-----------------|----------------|----------------|----------------|---------------------|----------------|
| | d _d | h _{nom} | h _{ef} | L _a | L ₁ | d _s | l _s | d ₁ |
| TermoZ CS II 8/115 DT 110 V | 8 | 32,5 | 25 | 95-115 | 42 | 5,4 | L _a + 10 | 9,5 |
| TermoZ CS II 8/135-255 DT110 V | | 32,5 | 25 | 135-255 | 52 | | | |
| | | 52,5 | 45 | | | | | |
| TermoZ CS II 8/275-295 DT 110 V | | 32,5 | 25 | 275-295 | 76 | | | |
| | | 52,5 | 45 | | | | | |
| TermoZ CS II 8/315-375 DT 110 V | | 32,5 | 25 | 315-375 | 156 | | | |
| | | 52,5 | 45 | | | | | |
| TermoZ CS II 8/395-455 DT 110 V | | 32,5 | 25 | 395-455 | 236 | | | |
| | | 52,5 | 45 | | | | | |

All dimensions in [mm]

fischer TermoZ CS II 8 and fischer TermoZ CS II 8 DT 110 V

Product description
Marking of plates
Dimensions of anchors

Annex A6

| Table A7.1: Materials | |
|---|--|
| Designation | Material |
| Anchor sleeve / shaft | PP, colour: grey |
| Specific compound screw TermoZ CS II 8 / TermoZ CS II 8 DT 110 V | PA6, GF with galvanised steel Zn5/Ag or Zn5/An as per EN ISO 4042 |
| Cap | Soft wood fibre; polystyrene; mineral wool |
| Anchor plate / Slip-on plate | PA6, GF colour: grey, blue, green, orange, red, yellow, black, mocca-latte |

Drawing of the slip-on plate (e.g. DT 140)

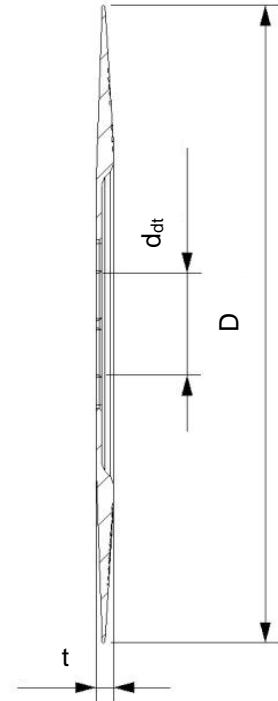
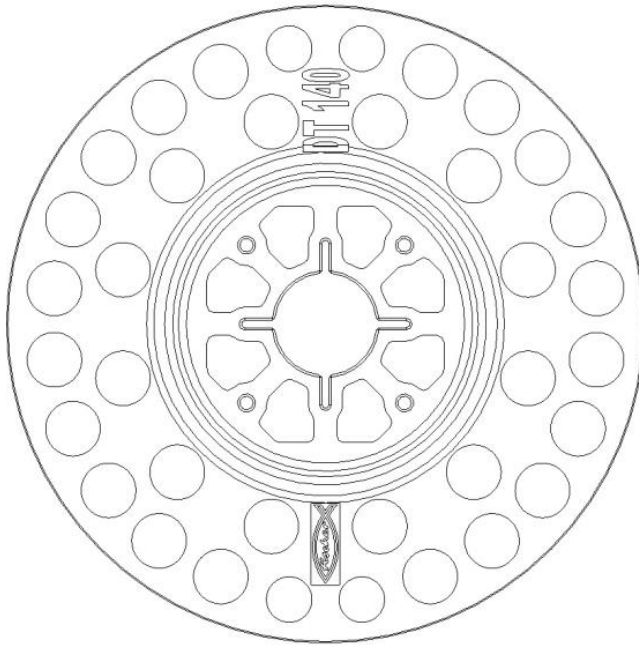

Table A7.2: Slip-on plates, diameters

| Slip-on plate | D [mm] | d_{dt} [mm] | t [mm] |
|-------------------------|-------------------|--------------------------------|-------------------|
| DT 90 / DT 110 / DT 140 | 90 / 110 / 140 | 22,5 | 3,9 |

Figures not to scale

fischer TermoZ CS II 8 and fischer TermoZ CS II 8 DT 110 V

Product description

Materials and dimensions of slip-on plates

Annex A7

Specifications of intended use

Anchorage subject to:

- The anchor may be used for transmission of wind suction loads.
- Additionally the anchor may be used for transmission of dead loads of thermal insulation panels with or without rendering on bottom side of ceilings.
- Anchors may be used for fixing of thermal insulation panels with or without rendering on bottom side of ceilings in concrete with or without supplementary adhesive. The product can only be used for ETICS with the following parameters:
 - for use of insulation panels with a tensile resistance equal and more than 80 kPa - adhesion of ETICS's rendering to the insulation panel shall be at least 80 kPa.
 - for use of insulation panels with a tensile resistance less than 80 kPa - adhesion of ETICS's rendering to the insulation panel shall be at least as high as nominal tensile resistance of a panel.

Base materials:

- Normal weight concrete without fibres \geq C12/15 (base material group "A") as per EN 206:2013+A1:2016, see Annex C1.

Note: only for use on bottom side of ceilings:

Reinforced or unreinforced concrete without fibres, strength \geq C12/15 (base material group "A") as per EN 206, see Annex C5.

- Solid masonry (base material group "B"), as per EN 771-1:2011+A1:2015, EN 771-2:2011+A1:2015, EN 771-3:2011+A1:2015, see Annex C1.
- Hollow or perforated masonry (base material group "C"), as per EN 771-1:2011+A1:2015, EN 771-2:2011+A1:2015 or EN 771-3:2011+A1:2015, see Annex C1 and C2.
- Lightweight aggregate concrete (base material group "D"), as per EN 1520:2011 / EN 771-3:2011+A1:2015, see Annex C2.
- Autoclaved aerated concrete (base material group "E"), as per EN 771-4:2011+A1:2015, see Annex C2.
- For other comparable materials of the base material groups "A", "B", "C", "D" and "E" the characteristic resistance of the anchor may be determined by job site tests according to EOTA Technical Report TR 051 Edition April 2018.

Temperature Range:

- 0 °C to + 40 °C (max. short term temperature + 40 °C and max. long term temperature + 24 °C) of the base material.

Design:

- The anchorages are designed under the responsibility of an engineer experienced in anchorages and masonry work with the partial factors $\gamma_M = 2,0$ and $\gamma_F = 1,5$ if there are no other national regulations.
- For use on bottom side of ceilings in concrete, anchorages are designed with partial safety factors $\gamma_{EPS} = 1,5$ for EPS insulation panels and $\gamma_{MW} = 2,0$ for mineral wool panels, if there are no other national regulations.
- Verifiable calculation notes and drawings are prepared taking account of the loads to be anchored. The position of the anchors is indicated on the design drawings.
- Fasteners are only to be used for multiple fixings of thermal insulation composite systems.
- For use on bottom side of ceilings in concrete at least 4 anchors per m² shall be used in insulation panels in absence of other national requirements.

fischer TermoZ CS II 8 and fischer TermoZ CS II 8 DT 110 V

Intended use
Specifications

Annex B1

Installation:

- Drilling method see Annex C1, C2 and C5.
- Anchor installation carried out by appropriately qualified personnel and under the supervision of the person responsible for technical matters on the site.
- Installation temperature of the anchor from 0 °C to + 40 °C.
- Exposure to UV due to solar radiation of the anchor not protected by rendering ≤ 6 weeks.
- The anchors have to be arranged depending on the used insulation material, the ETIC system and/or the system approval.
- For application on bottom side ceilings, it is possible to use the anchors without rendering or applying under UV protection longer than 6 weeks. If the anchors are not protected by rendering for the lifetime, the anchors must be covered by stainless steel or carbon steel with coating complying with corrosion resistance class 3 according to EN ISO 9223 or EN ISO 12944-2. Other materials are suitable if the evidence of non-UV transmission is provided. Yearly checks are required and damaged covers have to be replaced.

| | |
|---|-----------------|
| fischer TermoZ CS II 8 and fischer TermoZ CS II 8 DT 110 V | Annex B2 |
| Intended use Specifications | |

Table B3.1: Installation parameters for base material groups “A” concrete, “B” solid bricks, “C” hollow or perforated bricks, “D” lightweight aggregate concrete and “E” autoclaved aerated concrete

| Anchor type | | TermoZ CS II 8/95-455 TermoZ CS II 8/115-455 DT 110 V | |
|---|---------------------|--|---------------------------|
| | | flush | countersunk ¹⁾ |
| Nominal drill hole diameter | $d_0 =$ [mm] | 8 | 8 |
| Cutting diameter of drill bit | $d_{cut} \leq$ [mm] | 8,45 | 8,45 |
| Depth of drill hole to deepest point | $h_1 \geq$ [mm] | 40 | 55 |
| Overall plastic anchor embedment depth in the base material | $h_{nom} \geq$ [mm] | 32,5 | 32,5 |
| Effective anchorage depth in the base material | $h_{ef} \geq$ [mm] | 25 | 25 |

¹⁾ Not possible for TermoZ CS II 8/95.

Table B3.2: Installation parameters alternative option for base material group “E” for higher loads

| Anchor type | | TermoZ CS II 8/135-455 TermoZ CS II 8/135-455 DT 110 V | |
|---|---------------------|---|-------------|
| | | flush | countersunk |
| Nominal drill hole diameter | $d_0 =$ [mm] | 8 | 8 |
| Cutting diameter of drill bit | $d_{cut} \leq$ [mm] | 8,45 | 8,45 |
| Depth of drill hole to deepest point | $h_1 \geq$ [mm] | 60 | 75 |
| Overall plastic anchor embedment depth in the base material | $h_{nom} \geq$ [mm] | 52,5 | 52,5 |
| Effective anchorage depth in the base material | $h_{ef} \geq$ [mm] | 45 | 45 |

Table B3.3: Minimum thickness of member, edge distances and spacing in all regulated base material groups

| Anchor type | | TermoZ CS II 8/95-455 TermoZ CS II 8/115-455 DT 110 V |
|-----------------------------|------------------|--|
| Minimum thickness of member | $h_{min} =$ [mm] | 100 |
| Minimum spacing | $s_{min} =$ [mm] | 100 |
| Minimum edge distance | $c_{min} =$ [mm] | 100 |

Scheme of edge distances and spacing
for base material group “A”, concrete, group “B” solid bricks, group “C” hollow or perforated masonry, group “d” lightweight aggregate concrete, group “E” autoclaved aerated concrete

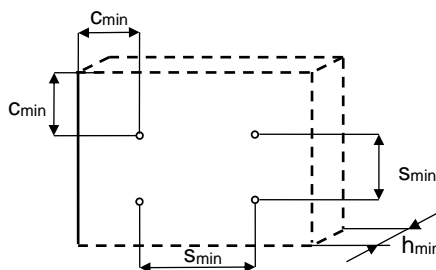

Figure not to scale

fischer TermoZ CS II 8 and fischer TermoZ CS II 8 DT 110 V

Intended use

Installation parameters depending on the base material groups
Minimum thickness of member, edge distances and spacings

Annex B3

Installation instruction

Standard setting of TermoZ CS II 8 (plain surface setting) without setting tool / exemplarily illustrated installation in the ceiling – installation in the wall / façade is also possible

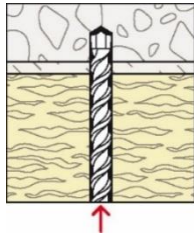

1. Drill hole by corresponding drilling method

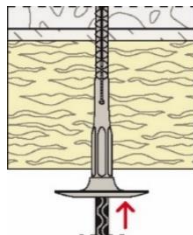

2. Insert anchor manually

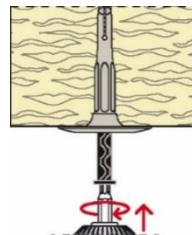

3. Set anchor by machine

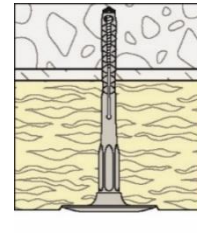

4. Correctly installed anchor

Setting of TermoZ CS II 8 (plain surface setting) by setting tool / exemplarily illustrated installation in the wall / façade – installation in the ceiling is also possible

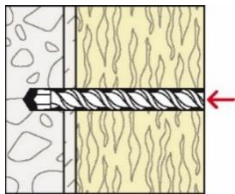

1. Drill hole by corresponding drilling method

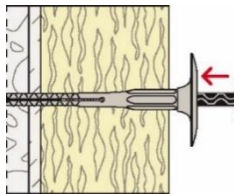

2. Insert anchor manually

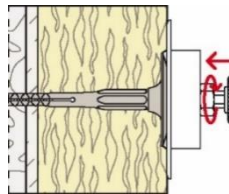

3. Set anchor by setting tool with the machine

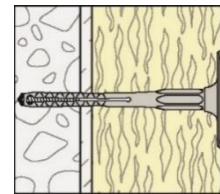

4. Correctly installed anchor

Setting of TermoZ CS II 8 (countersunk setting) by setting tool / exemplarily illustrated installation in the wall / façade – installation in the ceiling is also possible

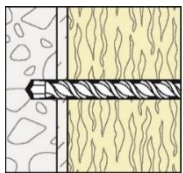

1. Drill hole by corresponding drilling method

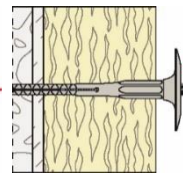

2. Insert anchor manually

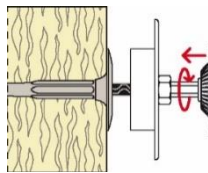

3. Put on setting tool

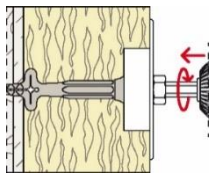

4. Set anchor by setting tool with the machine

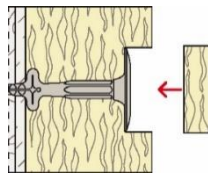

5. Put on cap

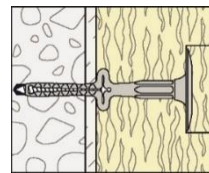

6. Correctly installed anchor

Setting of TermoZ CS II 8 DT 110 V by setting tool / exemplarily illustrated installation in the wall / façade – installation in the ceiling is also possible

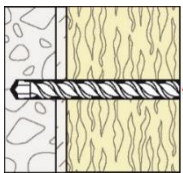

1. Drill hole by corresponding drilling method

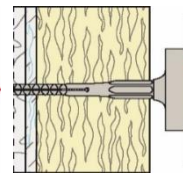

2. Insert anchor manually

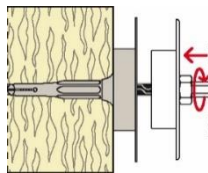

3. Put on setting tool

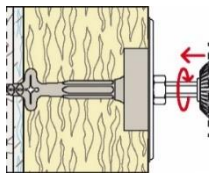

4. Set anchor by setting tool with the machine

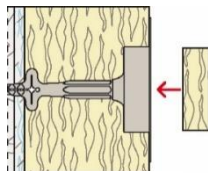

5. Put on cap

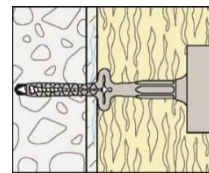

6. Correctly installed anchor

fischer TermoZ CS II 8 and fischer TermoZ CS II 8 DT 110 V

Intended use

Installation instruction for use in façade and for use on bottom side of ceilings

Annex B4

| Table C1.1: Characteristic resistance to tension loads N_{Rk} for single anchor TermoZ CS II 8 and TermoZ CS II 8 DT 110 V for façade use | | | | | | |
|---|-----------------|---|--|------------------------------|-------------------------------------|--|
| Base material | Group | Bulk density ρ [kg/dm³] | Mean compressive strength / minimum compressive strength single brick according to EN 771¹⁾ [N/mm²] | Remarks | Drilling method²⁾ | Characteristic resistance to tension loads N_{Rk} [kN] |
| Concrete ≥ C12/15 to ≤ C50/60, as per EN 206:2013+A1:2016 | A | - | - | - | H | 1,50 |
| Weather resistant concrete shell ≥ C20/25 as per EN 206:2013+A1:2016 | A | - | - | Thickness $h \geq 40$ mm. | H | 1,50 |
| Solid clay brick, Mz, as per EN 771-1:2011+A1:2015 | B ³⁾ | ≥ 1,8 | ≥ 25/20 | - | H | 1,50 |
| Calcium silicate solid brick, KS, as per EN 771-2:2011+A1:2015 | B ³⁾ | ≥ 1,4 | ≥ 15/12 | - | H | 1,50 |
| | | | ≥ 25/20 | | | |
| Solid lightweight concrete block, Vbl, as per EN 771-3:2011+A1:2015 | B ³⁾ | ≥ 1,4 | ≥ 10/8 | - | H | 1,20 |
| Solid concrete block, Vbn, as per EN 771-3:2011+A1:2015 | B ³⁾ | ≥ 2,0 | ≥ 15/12 | - | H | 1,50 |
| | | | ≥ 25/20 | | | |
| ¹⁾ The compressive strength of the single brick must not be less than 80% of the mean compressive strength. ²⁾ H = Hammer drilling, R = Rotary drilling. ³⁾ Vertically perforation ≤ 15%; cross section reduced by perforation vertically to the resting area. | | | | | | |
| fischer TermoZ CS II 8 and fischer TermoZ CS II 8 DT 110 V | | | | | Annex C1 | |
| Performances Characteristic resistance to tension loads | | | | | | |

**Table C2.1: Characteristic resistance to tension loads N_{Rk} for single anchor
TermoZ CS II 8 and TermoZ CS II 8 DT 110 V for façade use**

| Base material | Group | Bulk density ρ [kg/dm ³] | Mean compressive strength / minimum compressive strength single brick according to EN 771 ¹⁾ [N/mm ²] | Remarks | Drilling method ²⁾ | Characteristic resistance to tension loads N_{Rk} [kN] |
|--|-----------------|---|---|------------------------------------|-------------------------------|--|
| Vertically perforated clay brick, Hlz, as per EN 771-1:2011+A1:2015 | C ³⁾ | ≥ 0,9 | ≥ 15/12 | Exterior web thickness ≥ 12 mm. | R | 1,00 |
| | | | ≥ 15/12 | | H | 0,65 |
| | | ≥ 1,6 | ≥ 60/48 | | R | 1,50 |
| | | | ≥ 60/48 | | H | 1,50 |
| Hollow calcium silicate brick, KSL, as per EN 771-2:2011+A1:2015 | C ³⁾ | ≥ 1,4 | ≥ 15/12 | Exterior web thickness ≥ 23 mm. | H | 1,50 |
| Hollow brick lightweight concrete, Hbl, as per EN 771-3:2011+A1:2015 | C ³⁾ | ≥ 0,9 | ≥ 5/4 | Exterior web thickness ≥ 16 mm. | H | 0,50 |
| Hollow brick concrete, Hbn, as per EN 771-3:2011+A1:2015 | C ³⁾ | ≥ 1,2 | ≥ 5/4 | Exterior web thickness ≥ 38 mm. | H | 0,75 |
| | | | ≥ 7,5/6 | | | 1,10 |
| | | | ≥ 10/8 | | | 1,50 |
| | | | ≥ 12,5/10 | | | 1,50 |
| Lightweight aggregate concrete, LAC, as per EN 1520:2011 EN 771-3:2011+A1:2015 | D | ≥ 0,9 | ≥ 5/4 | - | H | 0,95 |
| | | | ≥ 7,5/6 | | | 1,50 |
| Autoclaved aerated concrete blocks, AAC, as per EN 771-4:2011+A1:2015 $h_{nom} = 32,5$ mm | E | ≥ 0,50 | ≥ 5/4 | - | R | 0,65 |
| Autoclaved aerated concrete blocks, AAC, as per EN 771-4:2011+A1:2015 $h_{nom} = 52,5$ mm ⁴⁾ | E | | | | | 1,10 |

¹⁾The compressive strength of the single brick must not be less than 80% of the mean compressive strength.

²⁾H = Hammer drilling, R = Rotary drilling.

³⁾Vertically perforation > 15 % and ≤ 50 %, cross section reduced by perforation vertically to the resting area.

⁴⁾Not possible for TermoZ CS II 8/95 and TermoZ CS II 8/115 and TermoZ CS II 8/115 DT 110 V.

| | |
|---|-----------------|
| fischer TermoZ CS II 8 and fischer TermoZ CS II 8 DT 110 V | Annex C2 |
| Performances Characteristic resistance to tension loads | |

Table C3.1: Plate stiffness according to EOTA Technical Report TR 026:2016-05

| Anchor type | Max. size of the anchor plate d_p [mm] | Load resistance of the anchor plate [kN] | Plate stiffness c [kN/mm] |
|-------------------------|--|--|-----------------------------|
| TermoZ CS II 8 | 60 | 2,61 | 1,29 |
| TermoZ CS II 8 DT 110 V | 110 | 2,61 | 1,29 |

Table C3.2: Point thermal transmittance according to EOTA Technical Report TR 025:2016-05

| TermoZ CS II 8 and TermoZ CS II 8 DT 110 V | h_{nom} [mm] | Thickness of insulation material h_D [mm] | Point thermal transmittance χ [W/K] | | | | | |
|--|----------------------|---|--|-------|-------|-------|-------|--|
| | | | Base material groups | | | | | |
| | | | A | B | C | D | E | |
| Mounting on the surface | 32,5 | 60 | 0,002 | 0,001 | | 0,000 | | |
| | | 80 | 0,002 | | 0,001 | | | |
| | | 100 - 120 | 0,001 | | | | | |
| | | 140 - 200 | 0,002 | | 0,001 | | | |
| | | 220 - 260 | 0,002 | | | 0,001 | | |
| | | 280 - 300 | 0,001 | | | 0,000 | | |
| | | 320 - 340 | 0,001 | | | | | |
| | | 360 - 400 | 0,000 | | | | | |
| | 52,5 | 420 | 0,001 | 0,000 | | | | |
| | | 100 - 120 | - | | | 0,001 | | |
| | | 140 - 240 | - | | | 0,001 | | |
| | | 320 | - | | | 0,001 | | |
| | Countersunk mounting | 32,5 | 80 - 200 | 0,001 | | | | |
| | | | 220 | 0,002 | | | 0,001 | |
| | | | 240 | 0,002 | 0,001 | | | |
| | | | 260 | 0,002 | | 0,001 | | |
| 280 | | | 0,001 | 0,000 | | | | |
| 300 | | | 0,001 | | 0,000 | | | |
| 320 - 340 | | | 0,001 | | | 0,000 | | |
| 360 - 420 | | | 0,000 | | | | | |
| 52,5 | | 100 - 120 | - | | | 0,000 | | |
| | | 140 - 240 | - | | | 0,001 | | |
| | | 320 | - | | | 0,000 | | |
| | | 400 | - | | | 0,000 | | |

| | |
|--|-----------------|
| fischer TermoZ CS II 8 and fischer TermoZ CS II 8 DT 110 V | Annex C3 |
| Performances Plate stiffness and point thermal transmittance | |

Table C4.1: Displacements of the TermoZ CS II 8 and TermoZ CS II 8 DT 110 V for façade use

| Base material | | Mean compressive strength / minimum compressive strength single brick according to EN 771 ¹⁾ [N/mm ²] | Tension load N _{Rd} [kN] | Displacements Δ(δ _N) [mm] |
|---|--|--|--|--|
| Concrete ≥ C12/15 ≤ C50/60, as per EN 206:2013+A1:2016 | | - | 0,50 | < 0,30 |
| Weather resistant concrete shell ≥ C20/25; as per EN 206:2011+A1:2016 | | - | 0,50 | < 0,30 |
| Clay brick, Mz, as per EN 771-1:2011+A1:2015 | | ≥ 25/20 | 0,50 | < 0,50 |
| Calcium silicate solid brick, KS, as per EN 771-2:2011+A1:2015 | | ≥ 15/12 | 0,50 | < 0,30 |
| | | ≥ 25/20 | 0,50 | |
| Solid lightweight concrete block, Vbl, as per EN 771-3:2011+A1:2015 | | ≥ 10/8 | 0,43 | < 0,40 |
| Solid concrete block, Vbn, as per EN 771-3:2011+A1:2015 | | ≥ 15/12 | 0,50 | < 0,30 |
| | | ≥ 25/20 | 0,50 | |
| Vertically perforated clay brick, Hlz, as per EN 771-1:2011+A1:2015 | rotary drilling | ≥ 15/12 | 0,33 | < 0,50 |
| | hammer drilling | | 0,22 | < 0,30 |
| | rotary drilling | ≥ 60/48 | 0,50 | < 0,40 |
| | hammer drilling | | 0,50 | |
| Hollow calcium silicate brick, KSL, as per EN 771-2:2011+A1:2015 | | ≥ 15/12 | 0,50 | < 0,40 |
| Hollow brick lightweight concrete, Hbl, as per EN 771-3:2011+A1:2015 | | ≥ 5/4 | 0,17 | < 0,20 |
| Hollow brick concrete, Hbn, as per EN 771-3:2011+A1:2015 | | ≥ 5/4 | 0,25 | < 0,20 |
| | | ≥ 7,5/6 | 0,37 | < 0,30 |
| | | ≥ 10/8 | 0,50 | < 0,40 |
| | | ≥ 12,5/10 | 0,50 | < 0,40 |
| Lightweight Aggregate Concrete, ≥ LAC as per EN 1520:2011 / EN 771-3:2011+A1:2015 | | ≥ 5/4 | 0,32 | < 0,50 |
| | | ≥ 7,5/6 | 0,50 | < 0,50 |
| Autoclaved aerated concrete blocks, AAC, as per EN 771-4:2011+A1:2015 | h _{nom} = 32,5 mm | ≥ 5/4 | 0,22 | < 0,20 |
| | h _{nom} = 52,5 mm ²⁾ | | 0,37 | |

¹⁾The compressive strength of the single brick must not be less than 80% of the mean compressive strength.

²⁾ Not possible for TermoZ CS II 8/95 and TermoZ CS II 8/115 and TermoZ CS II 8/115 DT 110 V.

| | |
|---|-----------------|
| fischer TermoZ CS II 8 and fischer TermoZ CS II 8 DT 110 V | Annex C4 |
| Performances Displacements | |

Table C5.1: Characteristic load bearing capacity of anchors per m² panel under short-term tension load $N_{Rk,panel,sh}$ [kN/m²] and long-term tension load $N_{Rk,panel,lg}$ [kN/m²] on bottom side of ceilings of the TermoZ CS II 8 and TermoZ CS II 8 DT 110 V

| Base material | Amount of anchors per m ² n_{panel} [-] | Short-term characteristic resistance for single anchor under tension load $N_{Rk,sh}$ [kN] | Characteristic resistance under short-term tension load $N_{Rk,panel,sh}$ [kN/m ²] | Long-term characteristic resistance for single anchor under tension load $N_{Rk,lg}$ [kN] | Characteristic resistance under long-term tension load $N_{Rk,panel,lg}$ [kN/m ²] |
|---|---|---|---|--|--|
| Concrete ¹⁾ ≥ C12/15 ≤ C50/60, as per EN 206:2013+A1:2016, Hammer drilling | n_{panel} | 0,65 | $0,65 \times n_{panel}^{2)}$ | 0,90 | $0,90 \times n_{panel}^{2)}$ |
| | 4 | 0,65 | 2,60 | 0,90 | 3,60 |
| | 16 | 0,65 | 10,40 | 0,90 | 14,40 |

¹⁾ Partial factor for concrete $\gamma_M = 1,80$.

²⁾ In case of different number of anchors per m².

Table C5.2: Displacement based on characteristic load bearing capacity per m² panel of the TermoZ CS II 8 and TermoZ CS II 8 DT 110 V for use on bottom side of ceilings

| Base material | Tension load N [kN] | Short-term δ_{sh} [mm] | Long-term δ_{lg} [mm] |
|---|--------------------------|----------------------------------|---------------------------------|
| Concrete ≥ C12/15 ≤ C50/60, as per EN 206:2013+A1:2016 | 0,27 | 0,06 | 1,10 |
| | 0,95 | 0,06 | 1,10 |

fischer TermoZ CS II 8 and fischer TermoZ CS II 8 DT 110 V

Performances

Characteristic load bearing capacity of anchors per panel
Displacement based on characteristic load bearing capacity per panel

Annex C5